



Eruberu. Co. Ltd

info@eruberu.co.jp
https://eruberu.co.jp

<Preparation> * LED resin is not included.
LED resin, Lamp, Scissors, Toothpick, Cotton swab,
Tweezers, Flat-nose pliers, File, Masking tape,
Kneaded eraser

<Not necessary but convenient>
Parts for tray, Embossing heat tool, Silicone mat,
Cardboard



Eruberu. Co. Ltd
https://eruberu.co.jp

FUK-117
レジンボックス
スイーツモーメント



Made in China



Basics

Q & A what is resin?

Resin is thermoplastic material that is hardened with the specific lamp. Resin is versatile and it can be used for coating parts and adhering parts.

Required time for hardening
Temporarily: Approx. 20-30 sec.
Fully: Approx. 1-2 min

The time required depends on the season, humidity and the size of your

* Image printed on instruction may have a certain level of color difference than actual object.

During work



Place a cardboard and a silicone mat under your work, so as to keep your work desk clean.

A

How to create the colored resin * Silicone cup is useful item for creating the colored resin.



1 Apply some clear resin to an OPP sheet. Add a small amount of coloring powder with a toothpick.

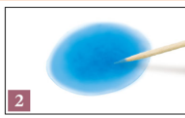

2 Grind powder and mix them. When the powder are mixed to a certain extent, mix the color and resin completely. Be careful not to cause air bubbles.

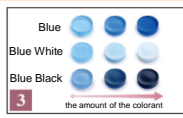

3 Repeat step 1 and 2 to suit your preference color.
* Brightness and saturation : control by mixing black or white.
* When mixing black or white, color becomes opaque color.

TIP

Resin may harden with sunlight, UV ray and fluorescent light.
* Create the colored resin before using.
* Work away from direct sunlight and UV ray. When you don't use lamp, please turn it off.

Careful not to put too much powder!
* Be careful not to put too much powder into the resin.
Resin may not harden. Also, the surface may not be flat after hardening. In this case, cover the surface with the clear resin.

B How to create the pattern



Apply the several colored resins to the mold. Blend the boundary layer with a toothpick or an embossing heat tool to create a smooth transition.



Apply the several colored resins to the mold, and stir them with a toothpick.

C How to use a silicone mold



1 Apply the resin to the mold.



2 If air bubbles form in the resin, use a toothpick to pop or an embossing heat tool and remove them before it hardens.

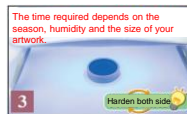

3 The time required depends on the season, humidity and the size of your artwork.
Harden both side.
4 Harden the resin with LED & UV lamp. Make sure to light it from upper side and lower side.



4 After hardening the resin completely, remove it from the silicone mold.
* When removing from the mold, do not excessively bend.

TIP

When using dark color resin or if the size is thick, pour resin to the mold in several layers. Resin will be hardened completely.

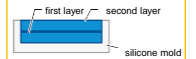

D How to cut a design film



Background
Cut the design out from the film without margin. That makes your work beautiful finished.



Clear film
Cut the film just inside of the line with scissors.



Letters and illustration
Cut the film along the design with scissors.

TIP
The print on a design film is delicate. If scratches with scissors or your finger nails, the print design will be damaged...
When the designs are difficult to see,
When the color of pattern is light, put it on a blank paper. It will be easier to see the pattern.

E How to use flowers



Cut the flower for your preference size. Dip flowers into the resin and cover them with resin.

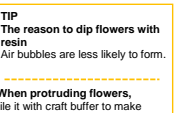

TIP
The reason to dip flowers with resin
Air bubbles are less likely to form.

When protruding flowers, file it with craft buffer to make smooth.

F How to decorate



Apply a thin layer of resin to a silicone mold, and place decorative parts onto it.

* When piling parts, apply resin between parts to adhere.

G How to remove burrs



After removing from the mold, filing with craft file (flat) makes it beautiful finish.



TIP
Coating the resin piece with clear resin after filing makes beautiful.
Before coating After coating

H How to attach decorative parts



1 Apply a thin layer of resin to the place where you want to put on.



2 Arrange the decorative parts before hardening the resin.

* When piling parts, apply resin between parts to adhere.

I How to coat parts



Coat an entire surface of the resin part with clear resin with a toothpick.

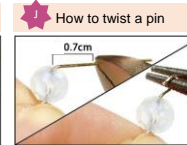

How to twist a pin
Thread a bead onto the eye pin/head pin. Make a 90 degree bend just above the bead with needle-nose pliers (pliers). Cut the pin, leaving a tail that's about 7mm/0.3inch long. Position the round nose pliers at the end of the tail. Wrap the wire toward you to create a loop.

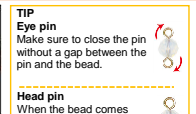

TIP
Eye pin
Make sure to close the pin without a gap between the pin and the bead.

Head pin
When the bead comes through the pin, use spangle.

K How to attach a jewelry findings



When using resin
Harden completely

1 Apply small amount of resin to the resin part, and attach a jewelry findings.

*Be careful of the direction.



Apply lamp to the cap from the side and the bottom, if needed.
* Be careful not to block the hole with resin.

2 To make sure, cover the bottom of the eyebolt cap with clear resin again.



When using craft bond glue

Apply the craft bond glue to the resin parts, and attach a jewelry findings.

TIP
When the resin parts is unstable, Fix the resin parts with masking tape or eraser before you start.

When you want to use large jewelry findings, lamp may not approach the middle of the parts. Please choose the appropriate way; resin or craft bond glue. If there is possibility that the parts touches your skin or hair, we recommend you to use craft bond glue.

L How to use a jump ring or the loop of the ball head pin



Jump ring / oval jump ring

1 Gently twist one pliers straight downward, and the other pliers straight upward to open the jump ring.



2 Connect it to whatever you're using, and grasp the jump ring the same way again with both pliers. Gently bend one pliers up and the other pliers down to close the jump ring again.



Head pin / eye pin / ball head

Gently twist one pliers straight toward you.

Attention

● Resin

Read instruction of prepared resin before start. (Prepare the tool as necessary) **Work away from direct sunlight and UV ray.** Ventilate the room. When you don't use lamp, please turn it off.

● Silicone mold

Wipe the dust and dirt from silicone mold before use. Do not use with food. Do not eat or swallow. A silicone mold is perishable goods. It will degrade after many years and uses. When using under the degraded condition, it may be difficult to remove your artwork from the mold. When using with colored material, the color may stain on the mold. Wipe it off before reuse. When removing from the mold, do not use a spatula, or do not excessively bend. The mold and your artwork may be damaged. Do not put a silicone mold on a printed paper, it may be stained with ink. When producing a three-dimensional shape silicone mold, material to have heat-resistant, elasticity and strength, and prevent from deterioration is put in the mold. Because of that, the color of the mold may be yellowish, and also the color will be much yellower with time. This is unavoidable phenomenon to maintain the characteristics, but it does not have an effect on creating resin artwork.

[storage]
Do not store in direct sunlight and avoid dirt. Keep out of reach of children and pets. Keep away from heat. The shape may change. Do not put one over another when storage. Depending on the storage condition, durability may change. Dispose of them according to your local regulations.

● Metal parts

As the color of plate coating may be affected if they were touched with sweat or stored in dirt, please wipe away the sweats or dirt's with a soft cloth before you store them. We also recommend you to store the metal parts in a bag with zipper. Please never wipe the metal parts with jewelry polishing cloth containing abrasive material, that will affect the color of the plate coating.

● Spinner

Do not put resin to the spinning parts of spinner. Otherwise, the parts will not spin. Keep out of reach of children and pets.

How to make

- ★ Closely refer to <Basics> (on a separate sheet) before starting your work.
- ★ Please feel free to arrange the resin projects!

Coloring powder in this kit



Color palette

Color A = white

Color B = white + pink + blue

Color C = blue + white

Color D = pink + blue + white

Color E = white + pink + blue

Color D = pink + blue + white

Color E = white + pink + blue

Color E = white + pink + blue

Color E = white + pink + blue

Color E = white + pink + blue

TIP

Pour the resin to the silicone mold until it is full.

※ If the amount of the resin is not full, the bottom surface may sink after harden.

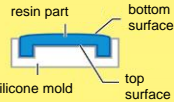

Preparation

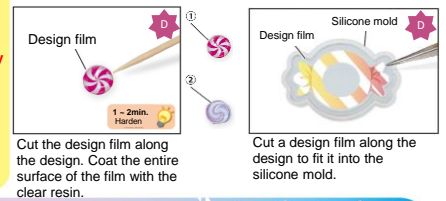

Project A: Float Charm



sample Image



※ Refer Color palette
Color A Color B Color C
Color D Color E
Colored resin you create

Create the colored resin right before pouring to the silicone mold.

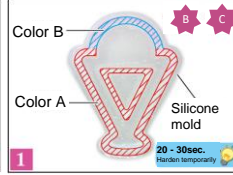

Apply the colored resin to the silicone mold until it is full. Apply the colored resin "A" first, and then pour "Color B". Make gradation. Harden 20-30 sec.

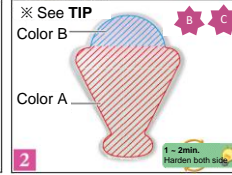

Apply the colored resin to the silicone mold until it is full. Apply the colored resin "A" first, and then pour "Color B". Make gradation. Harden 1-2 min.
* Harden back side longer to make sure.



Remove the resin part from the silicone mold.

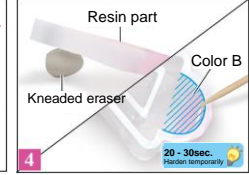

Fix the resin part with a kneaded eraser as shown in the picture above. Apply the colored resin to until it is half full. Keep this angle, and harden temporarily.



Apply more colored resin to the mold. Harden temporarily.

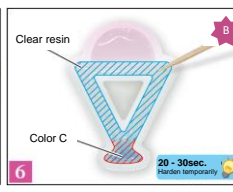

Apply the colored resin and clear resin to until it is half full. Apply the colored resin "C" first, and then pour clear resin. Harden 20-30 sec.

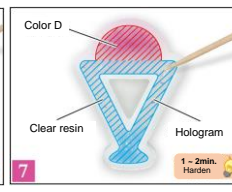

Apply clear resin first and pour the colored resin to. Arrange holograms to. Harden 1-2 min.
* Be careful that colored resin doesn't flow into.
* Hologram will be used in project B.



Put chaton into the space of the resin part as shown in the picture above.
* Do not use chaton all. Chaton will be used in project B.



Apply a thin layer of resin to and cover the space with the design film. Harden it 20-30 sec.

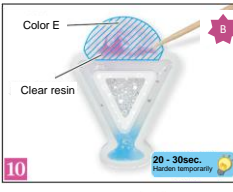

Apply clear resin to, and add the colored resin. Create marble pattern as shown in the picture above. Harden 20-30 sec.



Apply a thin layer of clear resin to the entire surface, and put the design film onto it. Harden it temporarily.

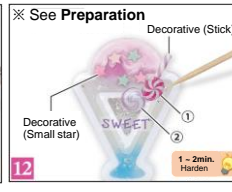

Apply the clear resin to the entire surface, and put decorative parts onto it. Harden it completely.
* Small star parts will be used at project B.



Attach jewelry findings to the resin part as shown in the picture above.

Done!!

Project B: Candy charm



sample Image

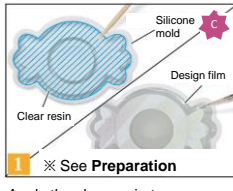

Apply the clear resin to until it is 9/10 full. Place the design film face down.



Apply the clear resin to the silicone mold until it is full.
* Harden the back side longer to harden completely.



Remove the resin piece from the silicone mold.

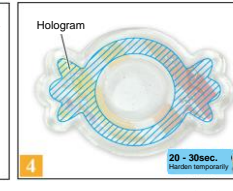

Apply the clear resin to until it is half full. Place hologram into it. Harden it temporarily.
* Hologram will be used in Project A.

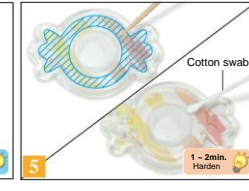

Apply the clear resin to until it is full. Harden it 1-2 min.
* Wipe the overflowed resin with a cotton swab.

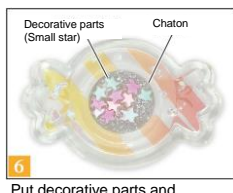

Put decorative parts and chatons into the space in the resin parts.
* Small star parts will be used at project A.



Apply a thin layer of clear resin to, and put the design film onto it. Harden 20-30 sec. Cover the entire surface with the clear resin. Then harden it 1-2 min.

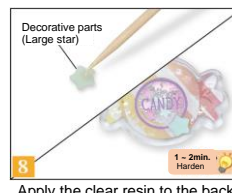

Apply the clear resin to the back of the decorative part (large star) and attach it to.
* To secure, add more resin to the joint.
* Harden resin parts from the back and side as needed.



Attach jewelry findings to the resin part as shown in the picture above.

Done!!



Choose your favorite!