

Home Décor Natural house
My most favorite place in the world



- [Tools needed]**
scissors / wet towel / pencil / toothpick / utility knife / cutting mat / craft bond glue / ruler
- [Not necessary but convenient]**
tray for parts / tweezers / paper / glue-gun / clothespin or hairpin (tools which hold something)

Read the following before you start.

- * Please check if the contents are all included.
- * Please follow the TIP, reference information, and images for your reference.
- * You will need:
a toothpick...to use bond glue.
a wet towel... to wipe your hands and to clean your place.
a paper... when using bond glue and not to get dirty.
tweezers... for detail work.
A glue gun is also useful instead of a traditional glue.
- * Flower images may vary to actual contents.

TIP

TIP 1

*The craft bands vary slightly in width or the number of twisted paper strings, depending on their colors.

Ensure use the correct color of band for each design element.



TIP 2

The parts will be fixed firmly if you hold them with a clothespin or hairpin until the craft bond glue dries.



Caution!
Keep out of reach of children and pets. Maybe harmful if swallowed.

Manufacturer: Eruberu Co., Ltd
2-1-20 Ekimae Ibaraki Osaka Japan <https://eruberu.co.jp/>

THE CONTENTS

Wooden board A		1
Wooden board B		1
Wooden board C		1
Wooden board D		1
Wooden board E		1
Wooden board F		1
Artificial flower		1 pouch
Starflower (blue)		2 pouches
Starflower (pink)		
Baby's breath		1 pouch
Preserved moss		1 pouch
Miniature ladder		1
Miniature window		1
Miniature bench		1
Cork		1
Craft band (black)		1
Craft band (red)		1
Paper parts		1 sheet

Instruction sheets 2 pages

* Image printed on instruction may have a certain level of color difference to the actual object. * The actual object may have certain differences compared with the image printed here. * For materials in this kit, their colors, shapes, sizes and pattern may vary, due to manufacturing process. Natural wooden plates are naturally generated, their colors and wood grain will not be identical. * The wooden plate may be warped slightly because of the excessive humidity.

[About Preserved moss, flowers]
* Preserved moss and flowers may get on your clothes, wall or floor. * If plants are exposed to fluorescent light or direct sunshine for long time, the colors may fade. Store in a cool, dry place away from direct sunlight. * Depending on the season, the colors, shapes and sizes of moss may vary. * This product is specially for craft. Do not eat.

How to make

Create a base

1 Paste wooden board A and B together with the craft bond glue.
*Go on to **3** after the glue dries.

If the wooden board warps upward, put the parts together as below.

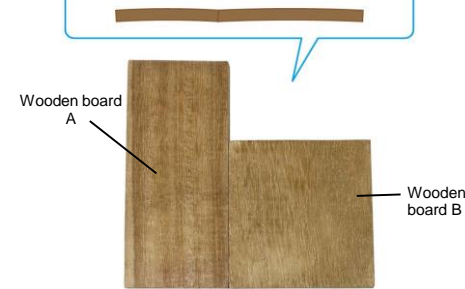

2 Cut out the paper parts as shown in the picture below.

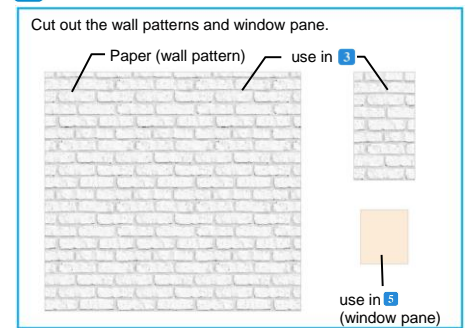

Cut out the part with the margins 0.5-1mm.
0.5-1mm Flower use in **11**

3 Apply craft bond glue to each parts, paste the wall pattern piece to the wooden board. Smooth out the wrinkles from the center to the edges to let the air out.
*Go on to **4** after the glue dries.

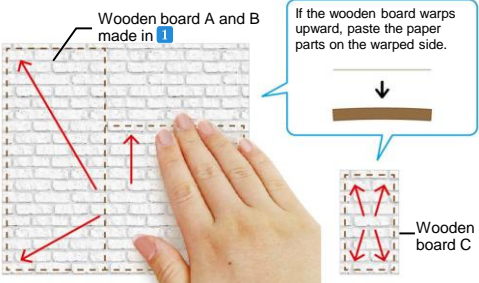

4 Turn **3** over, and cut off the protruding with utility knife.

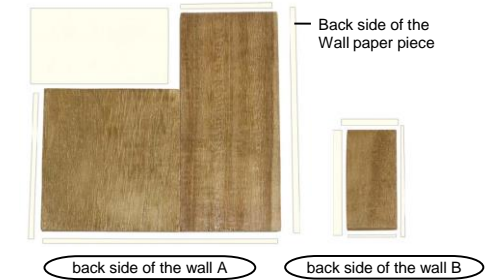

5 Apply craft bond glue to the back side of a miniature window, and paste the back side of the window pane piece to it.
*Go on to **6** after the glue dries.

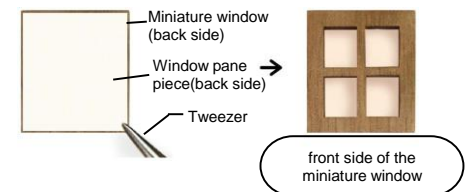

6 Lay down wall A, apply each part to it as shown in the picture below to make a base.
*Go on to **11** after the glue dries.

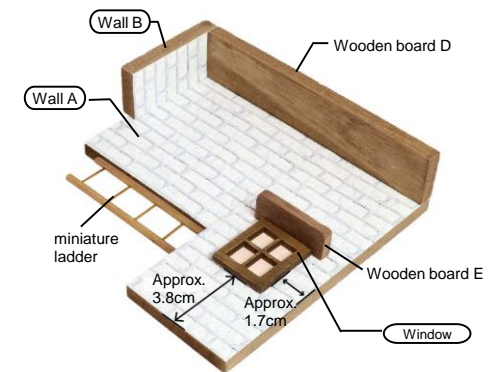

Create parts

7 Cut the craft band (black) into approx. 3cm x 1 and 4cm x 2. Split 3cm craft band into 6strings x 2 pieces.

TIP 1

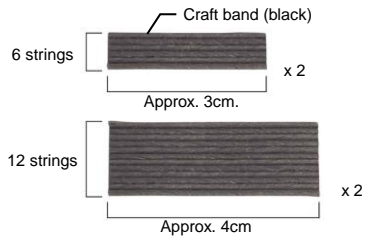

8 Wrap 7 around the pencil to make it into a tube, and apply the glue to the end of the craft band.

TIP 2

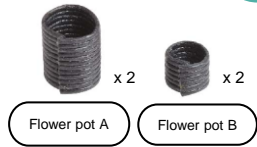

9 Cut the craft band (red) into approx. 3cm.

TIP 1

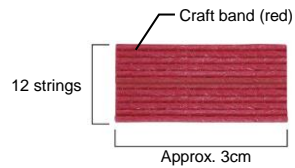

10 Paste wooden board F to 9 with the craft bond glue.

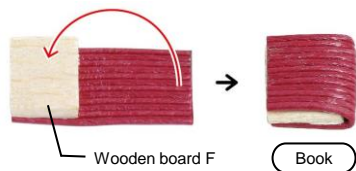

11 Attach each part to the base as Example of completed design.

* Attach the parts (shown in 1 2) first, so the following process will go more smooth.
* Cut flowers at the appropriate length depending on the spot you would like to attach.

Example of completed design

1 Arrange artificial flowers and preserved moss on the wall.

2 Split a cork in half. Arrange them with preserved moss, baby's breath and starflower (pink).

3 Arrange artificial flower, preserved moss, baby's breath and starflower (blue).

4 Arrange flower pot B with preserved moss and starflower (pink).

5 Place a miniature bench, paper part and book.

6 Arrange artificial flowers, preserved moss, baby's breath, starflower (pink).

7 Arrange flower pot A, preserved moss, artificial flower, starflower (blue), baby's breath on the corner.

Labels in callouts include: Artificial flower, Preserved moss, Baby's breath, Starflower (pink), Starflower (blue), Flower pot A, Flower pot B, Miniature bench, Book, Paper part cut out in 2, and Wooden board F.

*Lay down the base and attach those parts, and put the base upright again after those parts are fixed.