



**[ Tools needed ]**  
scissors / wet towel / pencil / toothpick / utility knife / cutting mat / craft bond glue / ruler

**[ Not necessary but convenient ]**  
tray for parts / tweezers / paper / glue-gun / clothespin or hairpin (tools which hold something)

**Read the following before you start.**

\* Please check if the contents are all included.  
\* Please follow the TIP, reference information, and images for your reference.

\* You will need:  
a toothpick... to use bond glue.  
a wet towel... to wipe your hands and to clean your place.  
a paper... when using bond glue and not to get dirty.  
tweezers... for detail work.  
A glue gun is also useful instead of a traditional glue.

\* Flower images may vary to actual contents.

**TIP**

**TIP 1**

\*The craft bands vary slightly in width or the number of twisted paper strings, depending on their colors.

Ensure use the correct color of band for each design element.

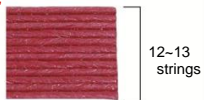

**TIP 2**

The parts will be fixed firmly if you hold them with a clothespin or hairpin until the craft bond glue dries.



**Caution!**  
Keep out of reach of children and pets. Maybe harmful if swallowed.

**Manufacturer: Eruberu Co., Ltd**  
2-1-20 Ekimae Ibaraki Osaka Japan <https://eruberu.co.jp/>

**Contents**

Wooden board A		1
Wooden board B		1
Wooden board C		1
Wooden board D		1
Artificial flower A		1 pouch
Artificial flower B		
Preserved moss		1 pouch
Starflower		1 pouch
Baby's breath (purple)		1 pouch
Baby's breath (white)		
Miniature table		1
Miniature chair		1
Miniature wooden box		1
Lace		1
Tulle lace		1
Craft band (white)		1
Craft band (brown)		1
Craft band (two-tone)		1
Paper part		1
Instruction sheets	2 pages	

\* Image printed on instruction may have a certain level of color difference to the actual object. \* The actual object may have certain differences compared with the image printed here. \* For materials in this kit, their colors, shapes, sizes and pattern may vary, due to manufacturing process. Natural wooden plates are naturally generated, their colors and wood grain will not be identical. \* The wooden plate may be warped slightly because of the excessive humidity.

[About Preserved moss, flowers]  
\* Preserved moss and flowers may get on your clothes, wall or floor. \* If plants are exposed to fluorescent light or direct sunshine for long time, the colors may fade. Store in a cool, dry place away from direct sunlight. \* Depending on the season, the colors, shapes and sizes of moss may vary. \* This product is specially for craft. Do not eat.

**HOW TO MAKE**

**Create a base**

**1** Cut out the wall paper and the sign.



**2** Apply the craft bond glue to the wooden board A and put the wallpaper onto it. Smooth out the wrinkles from the center to the edges to let the air out. \*Go on to 3 after the glue dries.

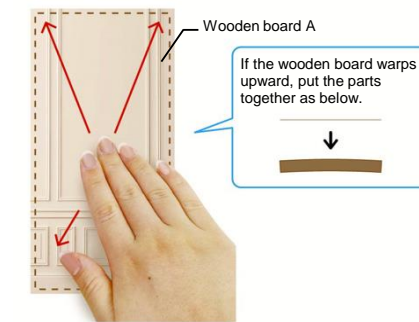

**3** Turn 2 over and cut off the protruding with the utility knife.



**4** Lay down the wall and attach wooden boards and a box to the wall with the craft bond glue as below. \*Go on to 6 after the glue dries.

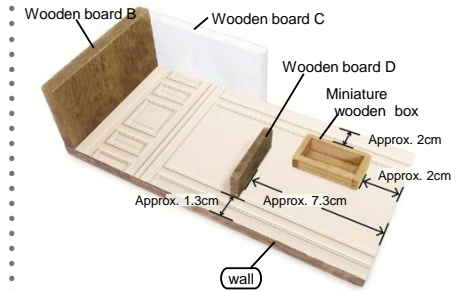

**5** Cut the craft band (white) into approx. 8.5cm x 1, and split it 7 strings, 4 strings and 2 strings.

**TIP 1**

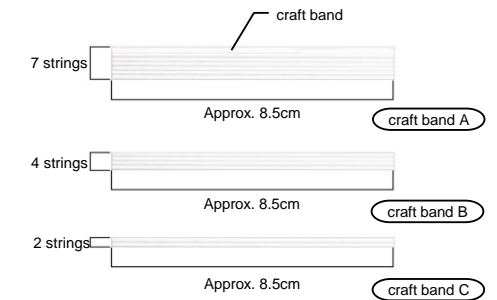

**6** Paste craft band A on the wall, paste craft band B on the band A and craft band C on the band B. Cut off the protruding. \*Go on to 11 after the glue dries.

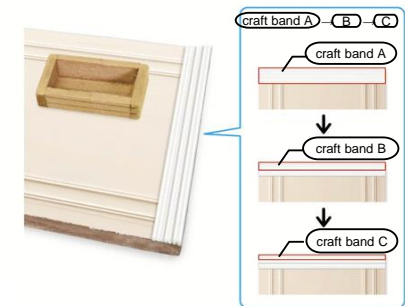

Create parts

7 Cut the craft band (brown) into approx. 4cm and 3cm. Split 3cm craft band into 6 strings x 2 pieces.

TIP 1

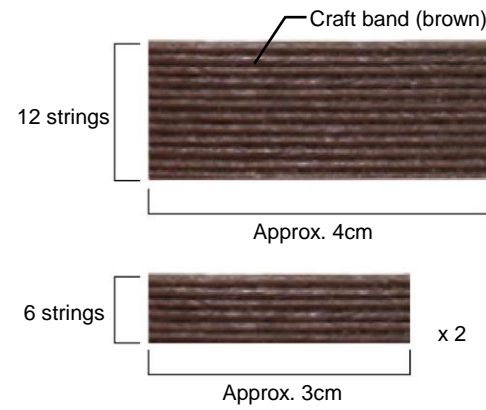

8 Wrap 7 around a pencil to make into a tube and apply craft bond glue to the end of the craft band.

TIP 2

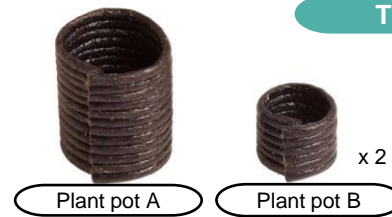

9 Cut the craft band (two-tone) into approx. 4cm and 3cm. Split 4cm and 3cm into 6 strings x 2 pieces each.

TIP 1

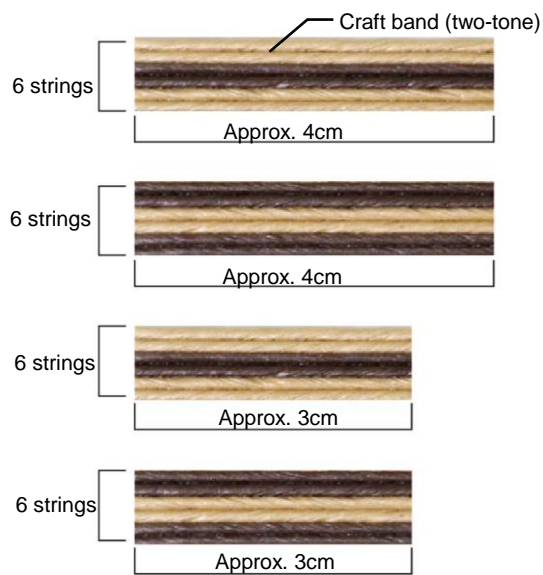

10 Wrap 9 around a pencil to make into a tube and apply craft bond glue to the end of the craft band.

TIP 2



11 Attach each part to the base as Example of completed design.

\* Attach the parts (shown in 1 2 3) first, and the following process will go more smooth.  
\* Cut flowers and lace at the appropriate length depending on the spot you would like to attach.

Example of completed design

2 Arrange baby's breath (white, purple), starflower and preserved moss.

Baby's breath, Starflower, Preserved moss, Baby's breath

\*Lay down the base and attach those parts, and put the base upright again after those parts are fixed.

7 Arrange plant pot E, plant pot F, starflower and preserved moss as shown in the picture below.

Starflower, Preserved moss, Plant pot F, Plant pot E

3 Arrange plant pot A, artificial flower A.

Artificial flower A, Plant pot A

5 Arrange plant pot C, starflower, baby's breath and preserved moss.

Starflower, Preserved moss, Baby's breath (purple), Plant pot C

1 Tie the baby's breath with the tulle lace (7 x 2.5cm) and make a bouquet. Attach the moss on the wall first, then arrange the baby's breath bouquet on it.

Tulle lace Approx. 7 x 2.5cm, Baby's breath (white), Preserved moss

\*Lay down the base and attach those parts, and put the base upright again after those parts are fixed.

4 Arrange plant pot B, starflower, baby's breath (white, purple), preserved moss and the paper sign cut in 1

Starflower, Baby's breath (purple), Baby's breath (white), Preserved moss, Plant pot, Paper sign cut in 1

6 Place miniature chair and miniature table. Cut the tulle lace into approx. 3x2.5cm. Decorate the tulle and artificial flower B to the plant pot D. Hang the lace on the chair as shown in the picture below.

Artificial flower B, Tulle lace 3 x 2.5cm, Lace, Miniature chair, Miniature table, Plant pot D