

**[Tools needed]**

craft bond glue, utility knife, cutting mat, scissors, tweezers, ruler, pencils, toothpick, nippers, eyeleteer, needle-nose pliers, round-nose pliers

**[Not necessary but convenient]**

tray for parts, glue stick, wet wipes, papers

**[Materials included]**



\* Image printed on instruction may have a certain level of color difference to the actual object. \* The actual object may have certain differences compared with the image printed here. \* For materials in this kit, their colors, shapes, sizes and pattern may vary, due to manufacturing process. Natural wooden plate are naturally generated, their colors and wood grain will not be identical. \* The wooden plate may be warped slightly because of the excessive humidity.

**[About Preserved moss and flowers]**

\* Preserved moss and flowers may get on your clothes, wall or floor. \* if they are exposed to fluorescent light or direct sunshine for long time, the colors may fade. Store in a cool, dry place away from direct sunlight. \* Depending on the season, the colors, shapes and sizes of moss and flowers may vary. \* This product is specially for craft. Do not eat.

**Read the following before you start.**

\* Please check if the contents are all included. \* Please follow the TIP, reference information, and images for your reference.

\* You will need:

- a wooden stick...to use bond glue.
- a wet towel... to wipe your hands and to clean your place.
- a paper... when using bond glue and not to get dirty.
- tweezers... for detail work.

A glue gun is also useful instead of a bond glue.

\* Please adjust the length of natural flowers and preserved moss based on the place where you want to use it. Divide the materials and dry run before finally fixing to the products.

\* Printed images may be come off when rubbing the paper parts with an eraser or a wet towel.

**Caution!**

Keep out of reach of children and pets. Maybe harmful if swallowed.

Manufacturer: Eruberu Co., Ltd

2-1-20 Ekimae Ibaraki Osaka Japan <https://eruberu.co.jp/>

**PREPARATION-REFERENCES**

**Craft band**



Ensure use the correct color of band for each design element.

\*The craft bands vary slightly in width or the number of twisted paper strings, depending on their colors.

**Curve the wire**

Bending in the opposite direction which has been bended makes it being deformed or split.

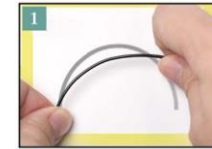

Curve the wire referring to the pattern sheet with your fingers or pliers.

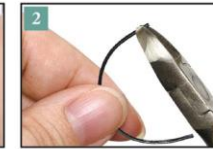

Cut off the excess with nippers.

**POINT**

Roll into a circle



Wrap it around a pen.

Curve the edge



Pinch the edge with Pliers and bend it.

**Paste Paper parts on one side.**

\* When you work on, please refer to the numbers printed here. Only numbers are printed in HOW TO MAKE section instead of parts name.



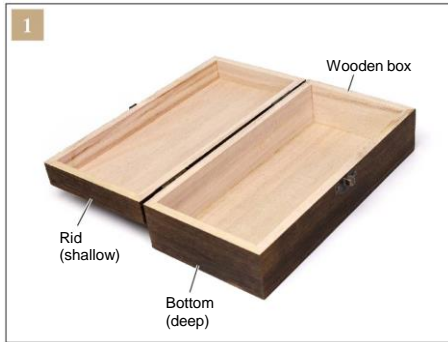

Unlock the wooden box and place it with the lid open.  
\* Place something under the lid so that the rims of the lid and bottom are horizontal.

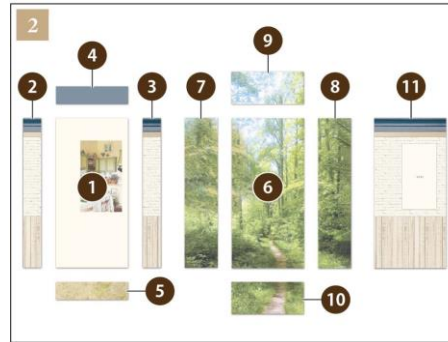

Cut out paper parts.

**POINT** Wooden box may be warped because it is a natural product. When pasting paper parts inside the box, measure the sizes where you would like to paste and cut the paper parts to fit them.

Cut the parts (2~4, 7~9) which will be pasted on 1~2mm shorter than actual size.

Align ★ to the inner corners of the wooden box.

Rid (shallow) Bottom (deep) Paste inside the rid Paste inside the bottom



Cut out 1 to fit 2.  
\* It is easier to work in the following process if you cut 1 at the same time.



Paste each part in the same way as 3.



Paste each part in the same way as 3.



Paste each part in the same way as 3.

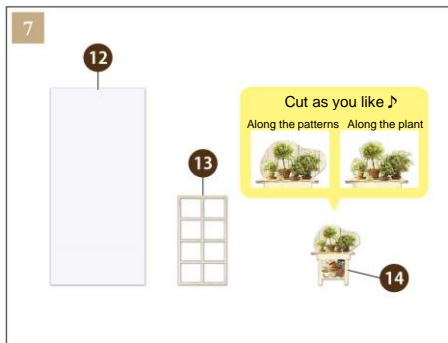

Cut out paper parts.

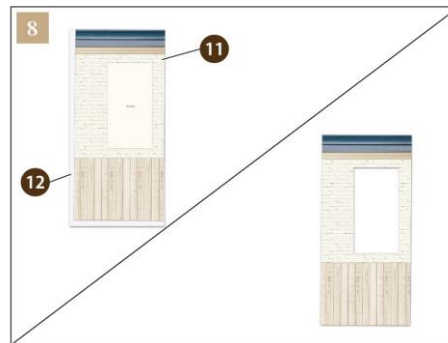

Paste 11 on 12 and cut out the protruding of 12 to fit in 11.

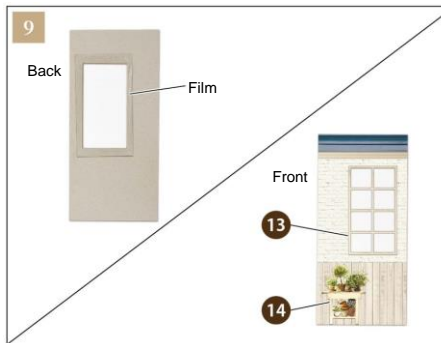

Paste each part together.

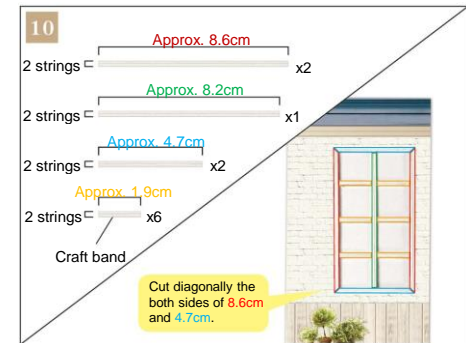

Cut the craft band (white) into approx. 8.6cm, and split it as shown in the picture above. Paste them on 9.



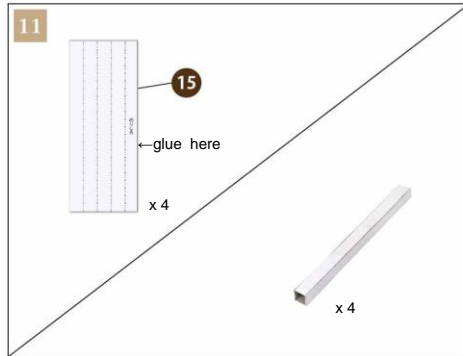

Cut out 15, make a crease on the dotted lines and fold into a mountain shape. Apply glue to the margins, paste together.



Paste 15 on 6.



Apply the glue to 19 and paste 9 on it.

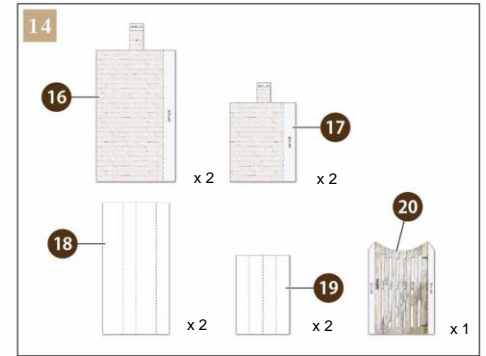

Cut out the paper parts.

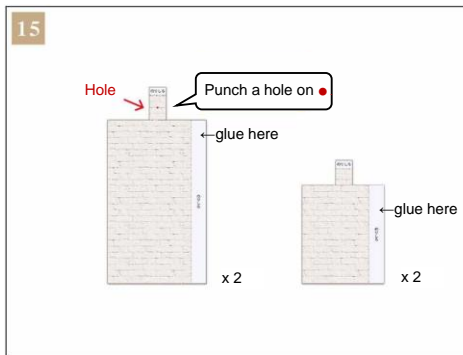

Make a crease on the dotted line of 16, 17 and fold them into a mountain shape.

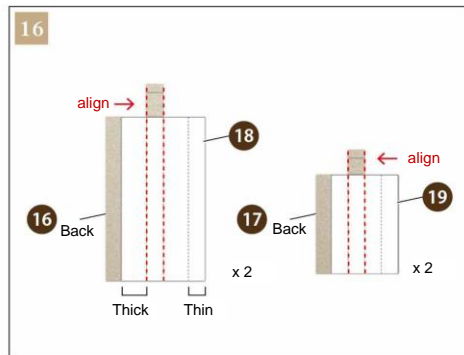

Turn them over and paste each part together.

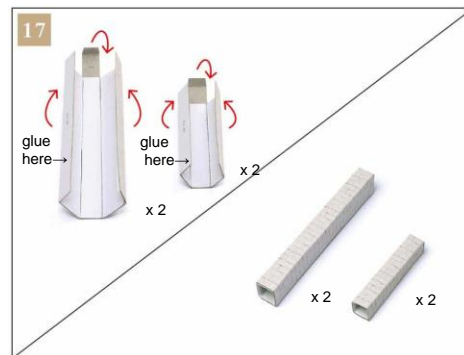

After the glue dries, make a crease on the dotted lines and fold it into a valley shape. Apply glue on the margins and paste together.



Paste 17 on 13.

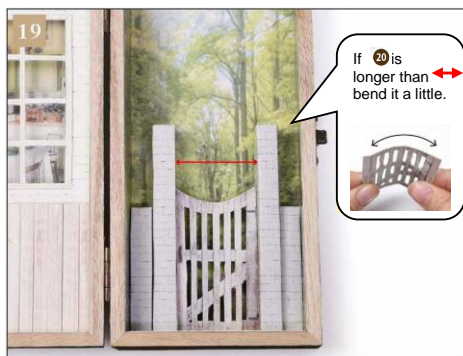

Paste 20

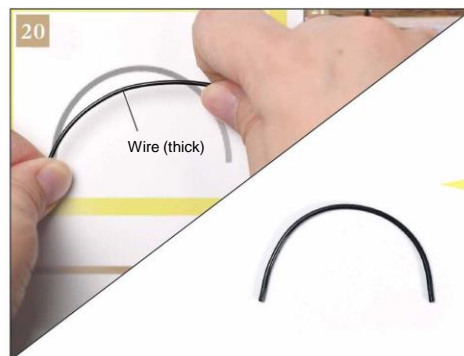

Curve the wire (thick) referring to the pattern sheet.

\* Please see Japanese instruction on page 3. There is an actual size pattern.

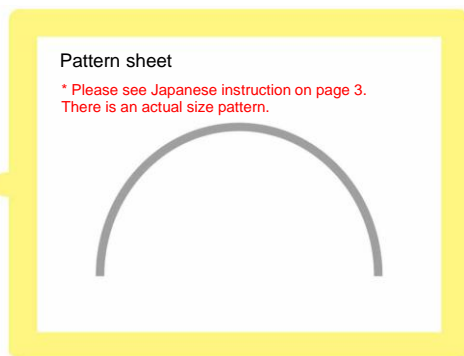

Put 20 into 16. \* Adjust the length of the wire to reach at the holes.

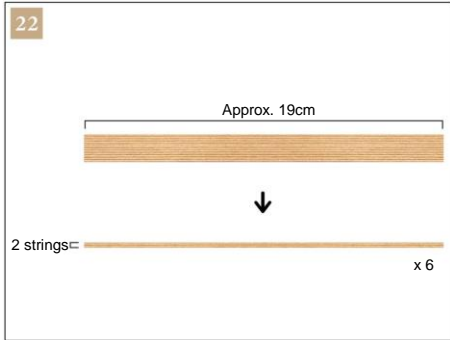

Cut the craft band into approx. 19cm and split it as shown in the picture above.



Cut **22** along blue lines and red lines. Then paste them onto there.

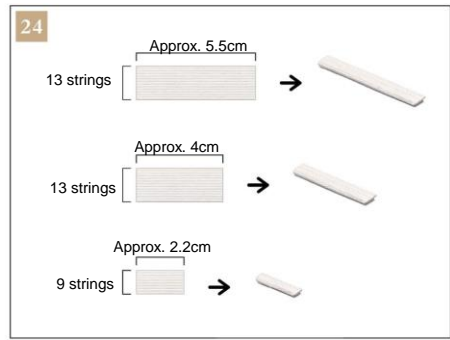

Cut the craft band into approx. 5.5cm, 4cm and 2.2cm, and split it as shown in the picture above. Apply the glue and fold them in half.



Paste **21** on **23** as shown in the picture above.

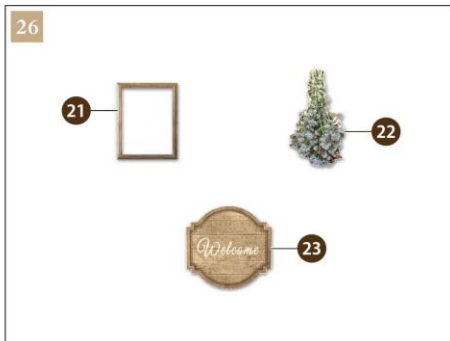

Cut out the paper parts.



Paste **22** on **21**.

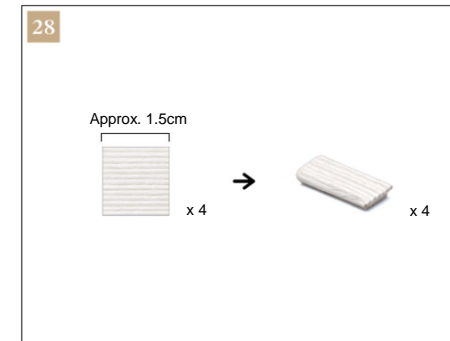

Cut the craft band into approx. 1.5cm x 4 pieces. Apply the glue and fold them in half.

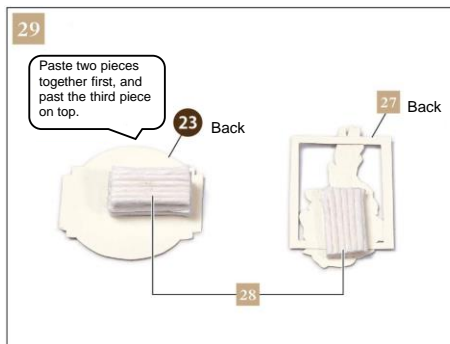

Paste each part together.

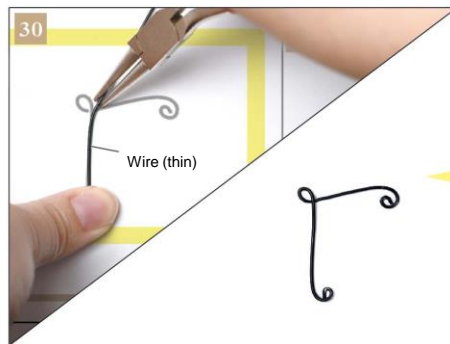

Bend the wire (thin) referring to the pattern sheet.

\* Please see Japanese instruction on page 4. There is an actual size pattern.

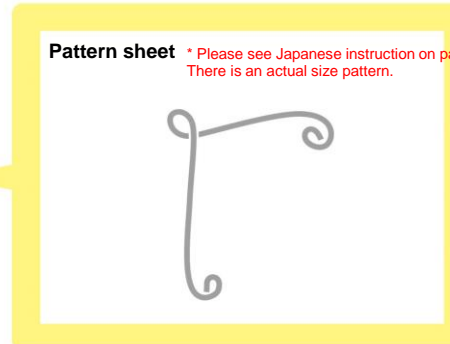

Paste **30** on the back of **23**.

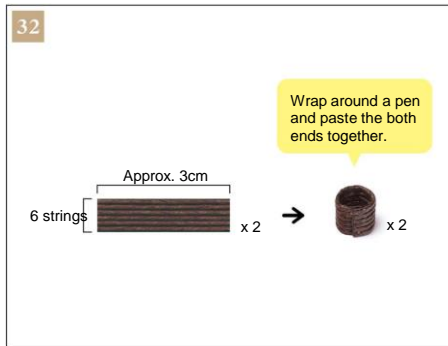

Cut the craft band (brown) into approx. 3cm and split it as shown in the picture above.

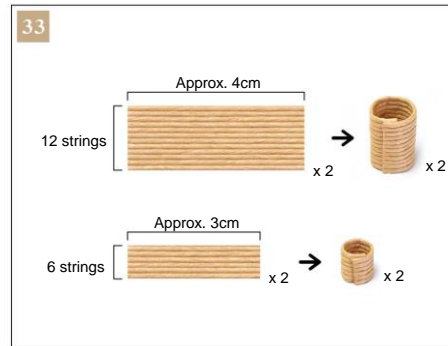

Cut the craft band (beige) into approx. 4cm x 2 pieces and 3cm x 1 piece. Split 3cm craft band as shown in the picture above to make parts in the same way as 32.

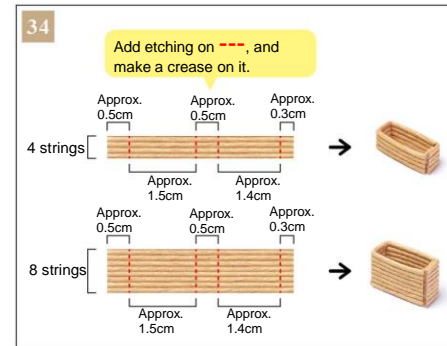

Cut the craft band (beige) into approx. 4.2cm, and split it as shown in the picture above. Create parts.

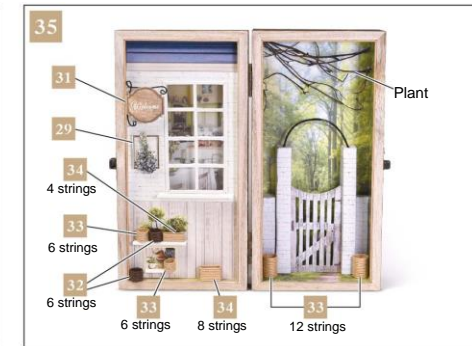

Paste each part together.



Paste each part together.  
\* Cut the plant parts into an appropriate length and divide into some bunches for your convenience.

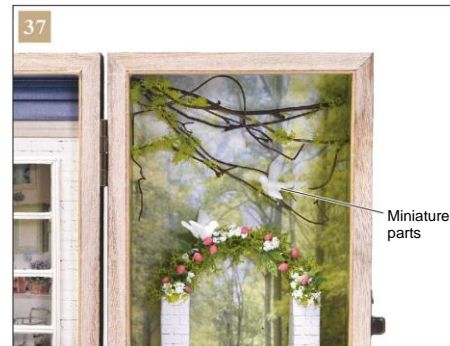

Paste miniature parts.

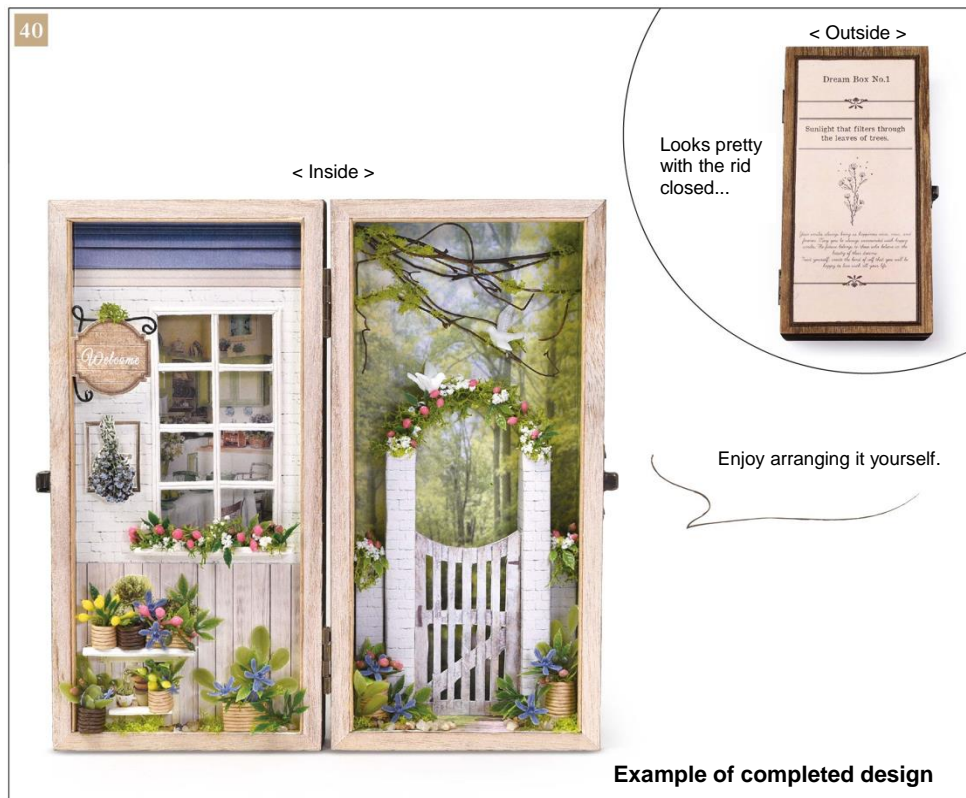

Example of completed design

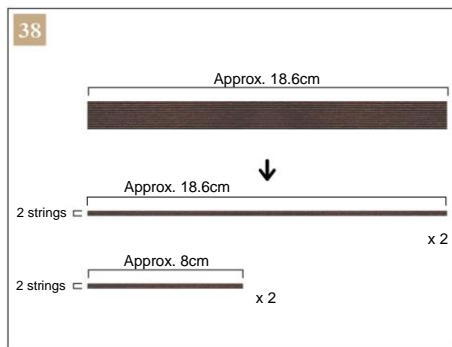

Split the craft band (brown) as shown in the picture above.

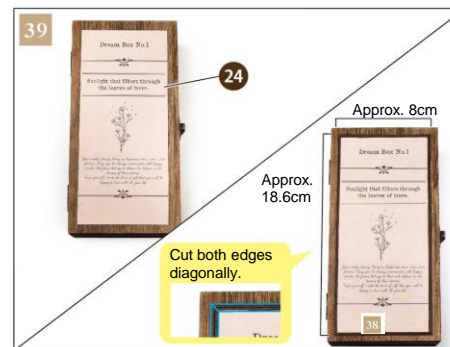

Cut out 24, and paste on the lid of the wooden box. Then paste 33 onto it.

Finish!