

**[Tools needed]**

craft bond glue, glue stick, utility knife, cutting mat, scissors, tweezers, ruler, pencils, toothpick, sand paper, nippers, eyeleteer, needle-nose pliers, round-nose pliers, scotch tape

**[Not necessary but convenient]**

tray for parts, glue-gun, wet wipes, papers, pens

**[Materials included]**



\* Image printed on instruction may have a certain level of color difference to the actual object. \* The actual object may have certain differences compared with the image printed here. \* For materials in this kit, their colors, shapes, sizes and pattern may vary, due to manufacturing process. Natural wooden plates are naturally generated, their colors and wood grain will not be identical. \* The wooden plate may be warped slightly because of the excessive humidity.

**[About Preserved moss]**

\* Preserved moss may get on your clothes, wall or floor. \* if moss are exposed to fluorescent light or direct sunshine for long time, the colors may fade. Store in a cool, dry place away from direct sunlight. \* Depending on the season, the colors, shapes and sizes of moss may vary. \* This product is

**Caution!**

Keep out of reach of children and pets. Maybe harmful if swallowed.

Manufacturer: Eruberu Co., Ltd

2-1-20 Ekimae Ibaraki Osaka Japan <https://eruberu.co.jp/>

**Read the following before you start.**

\* Please check if the contents are all included. \* Please follow the TIP, reference information, and images for your reference.

\* You will need:

- a wooden stick...to use bond glue.
- a wet towel... to wipe your hands and to clean your place.
- a paper... when using bond glue and not to get dirty.
- tweezers... for detail work.
- A glue gun is also useful instead of a bond glue.

\* Please adjust the length of natural flowers and preserved moss based on the place where you want to use it. Divide the materials and dry run before finally fixing to the products.

\* Printed images may be come off when rubbing the paper parts with an eraser or a wet towel.

**How to make**

**Separate the wooden pieces from the wooden plate**



Cut off the wood pieces with craft knife as shown in the picture above.

**Tip!**

\* This wooden plate is laser processed. Wipe cut surfaces to remove dirt and dust before use.  
\* Sand cut surfaces after removal.

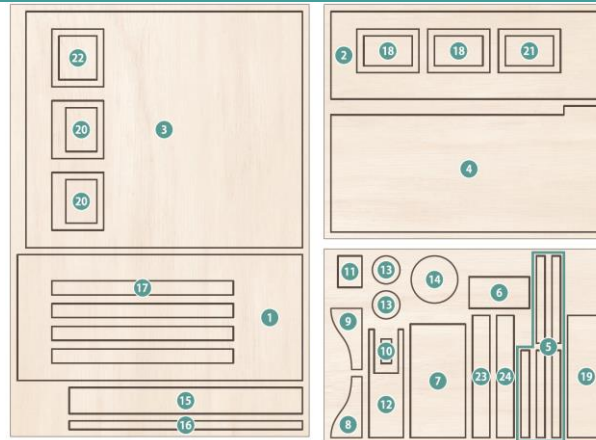

**Bend a wire**

Bend the wire with pliers as below. Cut the wire after creating the shape.

\* Extensive bending of wire may cause breakage.

**How to bend a wire (or create curve)**



Pinch the end of the wire with pliers, and bend it.

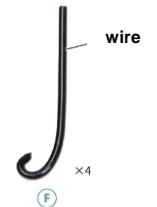

**Cut a craft band**

Ensure use the correct color of band for each design element.

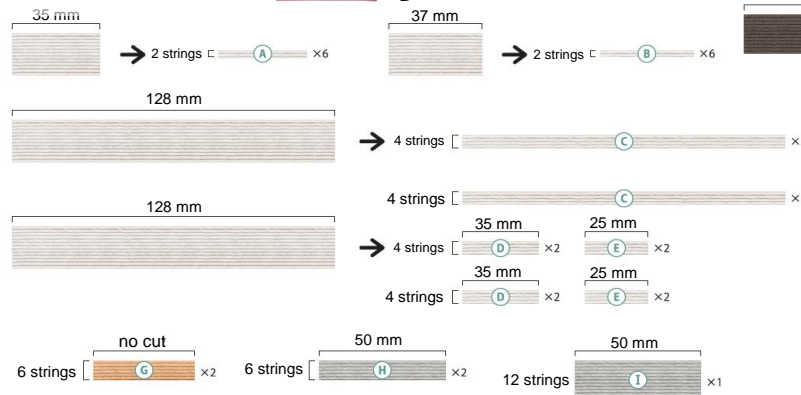
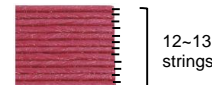

Add etching on the craft band with a craft knife and bend it.

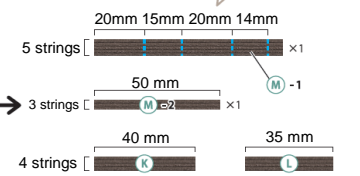

Add etching on the craft band and bend it.

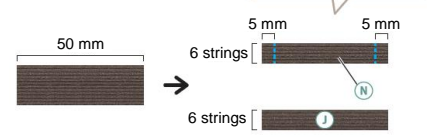

Please see numbers and letters: Paper parts ①~⑳ Wooden parts ①~⑳ Craft band ①~①

Paste paper parts to wooden pieces

Paste paper parts ①~⑳ to corresponding wooden pieces. Cut the excess paper off with scissors or a craft knife.

**1** Front surface \* Paper parts of the wooden pieces ⑧~⑩ are pasted in step 12

Back surface \* No paper on the back side of wooden pieces ④~⑦・⑫~⑭.

turn over all pieces →

Tape the paper parts to the wooden parts, and open holes with an eyeletter as below.

**2**

Long side  
short side

Long side  
short side

Paste from here

Paste from here

Create parts and assemble them

**3** Wrap the wooden pieces with paper parts in a C shape as below.

Wrap the wooden pieces with paper parts in an L shape as below.

**4** Cut an edge off the craft bands at 45 degrees and paste them as below.

Front surface

**5** Cut an edge off the craft bands C and D at 45 degrees and paste them as below.

Front surface

Back surface

**6** Front surface

Back surface



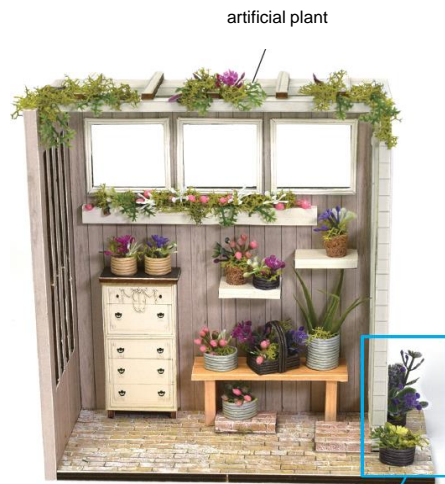
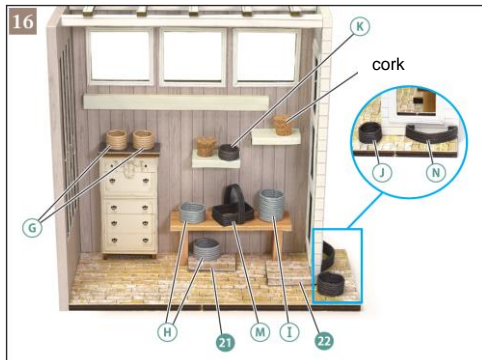
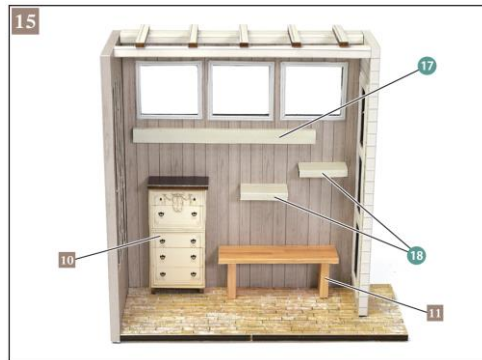
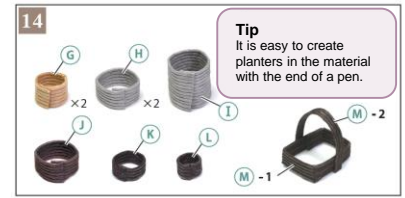
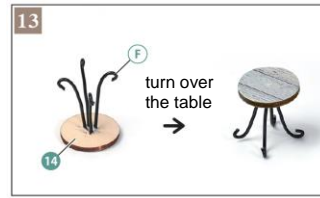
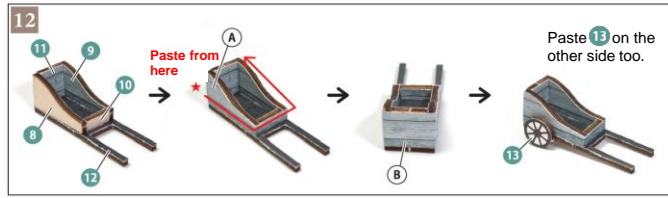
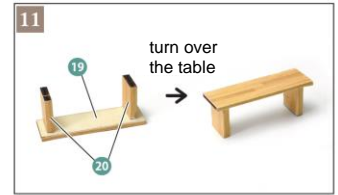

Example of completed design



artificial plant

L

13

miniature watering can