

[Tools needed]

craft bond glue, glue stick, utility knife, cutting mat, scissors, tweezers, ruler, pencils, toothpick, sand paper, nippers, eyeleteer, needle-nose pliers, round-nose pliers, scotch tape

[Not necessary but convenient]

tray for parts, glue-gun, wet wipes, papers, pens

[Materials included]



* Image printed on instruction may have a certain level of color difference to the actual object. * The actual object may have certain differences compared with the image printed here. * For materials in this kit, their colors, shapes, sizes and pattern may vary, due to manufacturing process. Natural wooden plate are naturally generated, their colors and wood grain will not be identical. * The wooden plate may be warped slightly because of the excessive humidity.

[About Preserved moss and flowers]

* Preserved moss and flows may get on your clothes, wall or floor. * if they are exposed to fluorescent light or direct sunshine for long time, the colors may fade. Store in a cool, dry place away from direct sunlight. * Depending on the season, the colors, shapes and sizes of moss and flowers may vary. *

Caution!

Keep out of reach of children and pets. Maybe harmful if swallowed.

Manufacturer: Eruberu Co., Ltd

2-1-20 Ekimae Ibaraki Osaka Japan <https://eruberu.co.jp/>

Read the following before you start.

* Please check if the contents are all included. * Please follow the TIP, reference information, and images for your reference.

* You will need:

- a wooden stick...to use bond glue.
- a wet towel... to wipe your hands and to clean your place.
- a paper... when using bond glue and not to get dirty.
- tweezers... for detail work.
- A glue gun is also useful instead of a bond glue.

* Please adjust the length of natural flowers and preserved moss based on the place where you want to use it. Divide the materials and dry run before finally fixing to the products.

* Printed images may be come off when rubbing the paper parts with an eraser or a wet towel.

How to make

Separate the wooden pieces from the wooden plate



Cut off the wood pieces with craft knife as shown in the picture above.

Tip!

- * This wooden plate is laser processed. Wipe cut surfaces to remove dirt and dust before use.
- * Sand cut surfaces after removal.

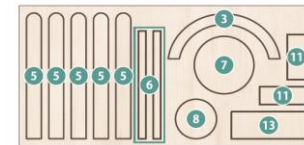
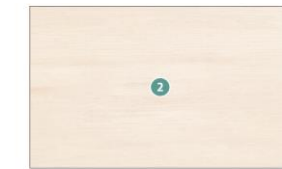
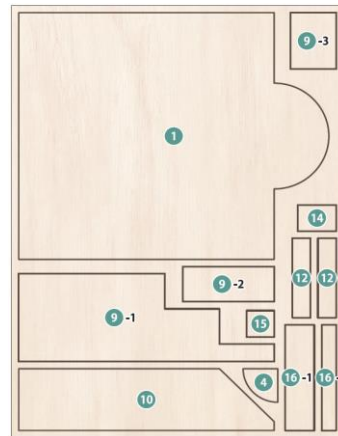

Cut a craft band

Add etching on the craft band with a craft knife and bend it.

Ensure use the correct color of band for each design element.

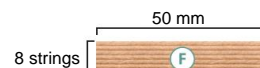
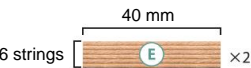
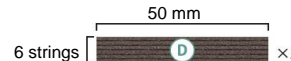
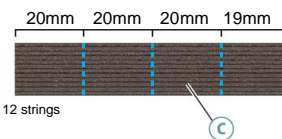
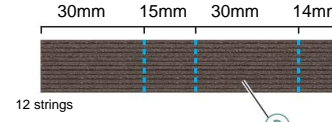
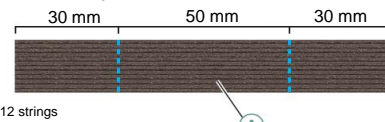
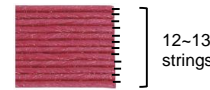

Bend a wire

Bend the wire with pliers as below. Cut the wire after creating the shape.

* Extensive bending of wire may cause breakage.

How to bend a wire (or create curve)



Pinch the end of the wire with pliers, and bend it.

Thin wire



Thick wire



Please see numbers and letters: Paper parts ①~⑩ Wooden parts ①~⑩ Craft band and wire ①~⑩

Paste paper parts to wooden pieces

Paste paper parts ①~⑩ to corresponding wooden pieces. Cut the excess paper off with scissors or a craft knife.

1 Front surface Back surface

* No paper on the back side of wooden pieces ②~④·⑦·⑧.

turn over all pieces

Open holes with an eyelet as below.

Tape the paper parts to the wooden parts, and open holes with an eyelet as below.

2 Front surface Front surface Back surface

Stick wooden pieces together with the glue.

turn over

3 Front surface Back surface

turn over

Paste from here

4 Wrap the wooden piece with paper. Wrap the wooden pieces in a C shape as below.

5 Paste from here

Paste from here

Open a hole with an eyelet as above.

6 Paste from here

Create parts and assemble them

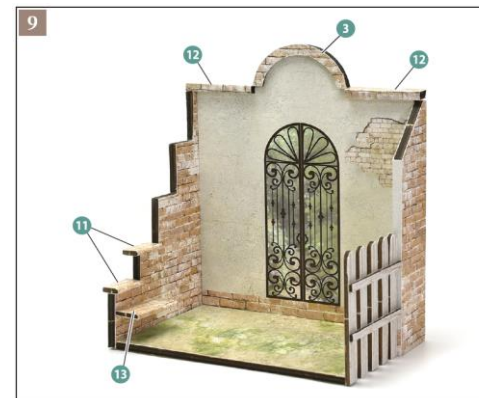
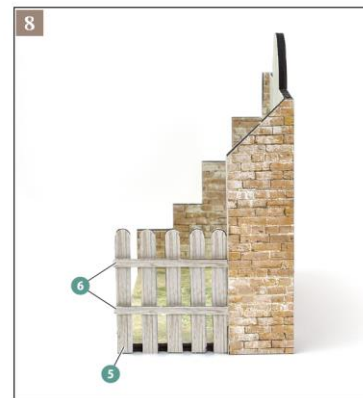
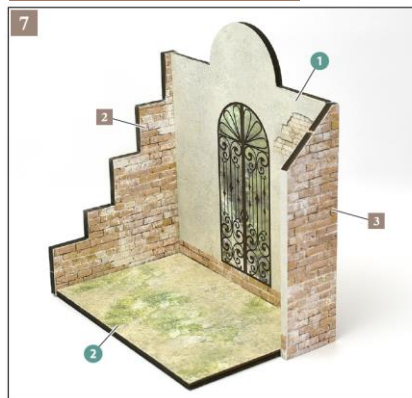

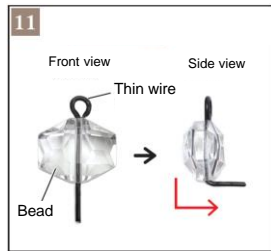

Bend a wire.

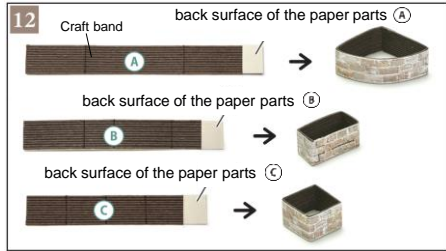

Paste paper parts to the craft band.

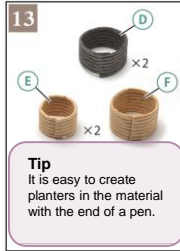

Tip
It is easy to create planters in the material with the end of a pen.

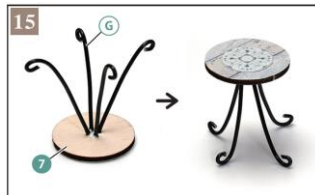

Tip
It is easier to fix the wire if the part is propped against the edge of the box as above until the glue dries. It is even better to use the scotch tape.

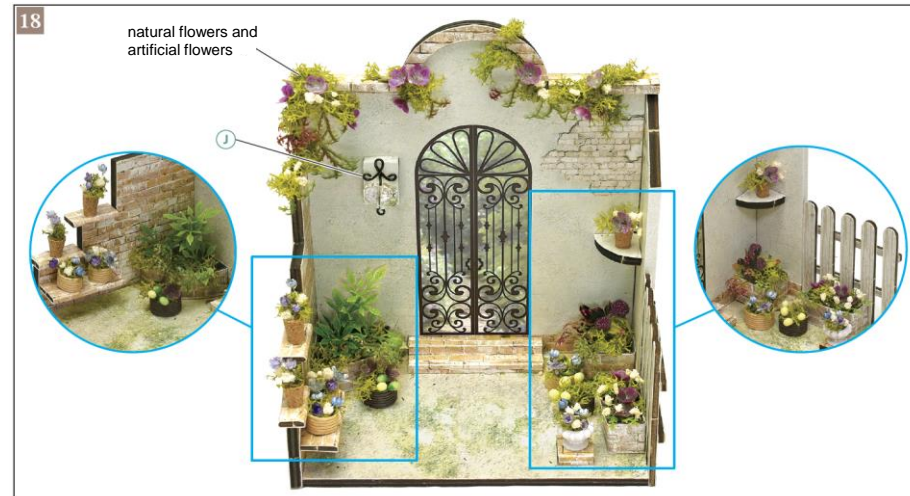
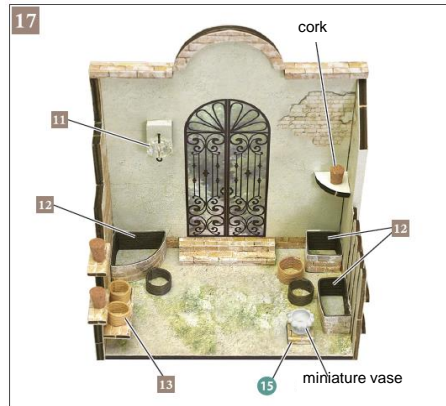

19

Example of completed design

