

[Tools needed]

paper palette, water cup, craft bond glue, glue stick, double-sided tape, scotch tape, utility knife, cutting mat, sand paper, scissors, tweezers, ruler, pencils, toothpick, needle-nose pliers, round-nose pliers, nippers, eyeleteer, cotton swab

[Not necessary but convenient]

tray for parts, wet wiper, tissue, paper, glue-gun

[Materials included]



* Images may vary to actual contents. * For materials in this kit, their colors, shapes, sizes and pattern may vary, due to manufacturing process. Natural wooden plates are naturally generated, their colors and wood grain will not be identical. * The wooden plate may warp slightly due to the excessive humidity. * Make an eye pin straight before use. * For the metal parts, it is possible to have certain amount of flaws on the surface, due to plate coating process. * Because of the polyester cloth, red thread may be stucked.

[About Preserved moss]

* Preserved moss may get on your clothes, wall or floor. * If moss is exposed to fluorescent light or direct sunshine for long time, the colors may fade. Store in a cool, dry place away from direct sunlight. * Depending on the season, the colors, shapes and sizes of moss may vary. * This product is specially for craft. Do not eat.

Caution!

Keep out of reach of children and pets. Maybe harmful if swallowed.

Manufacturer: Eruberu Co., Ltd

2-1-20 Ekimae Ibaraki Osaka Japan <https://eruberu.co.jp/>

Read the following before you start.

* Please check if the contents are all included. * Please refer to the images and TIP reference while building your model.

* You will need:

- a toothpick...to use bond glue and/or resin.
- a wet towel... to wipe your hands and to clean your workplace.
- paper... when using bond glue and to protect surfaces while working.
- tweezers... for detail work.
- A glue gun is also useful instead of a bond glue.

- * Please adjust the length of natural flowers and preserved moss based on the place where you want to use it. Divide the materials and dry run before finally fixing to the products.
- * Printed images may be come off when rubbing the paper parts with an eraser or a wet towel.

Example of completed design

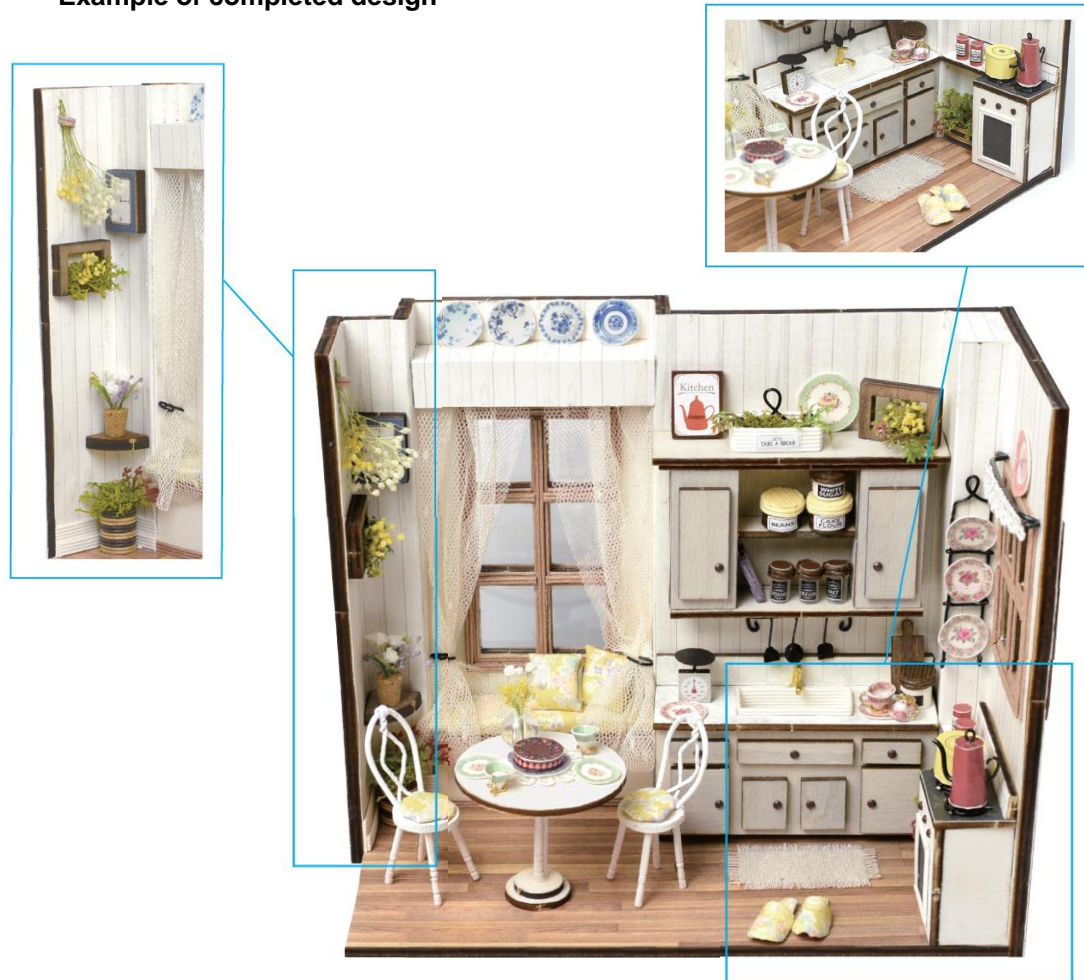

Painting

white	brown black 2 : 1	white black 1 : 1

White is used in 59. Black is used in 63 and 65.

Separating the wooden pieces from the wooden plate



Tip!
* This wooden plate is laser processed. Wipe cut surfaces to remove dirt and dust before use.
* Sand cut surfaces after removal.

Paint the wooden plates before separating plates.

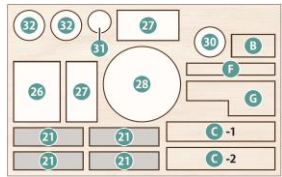
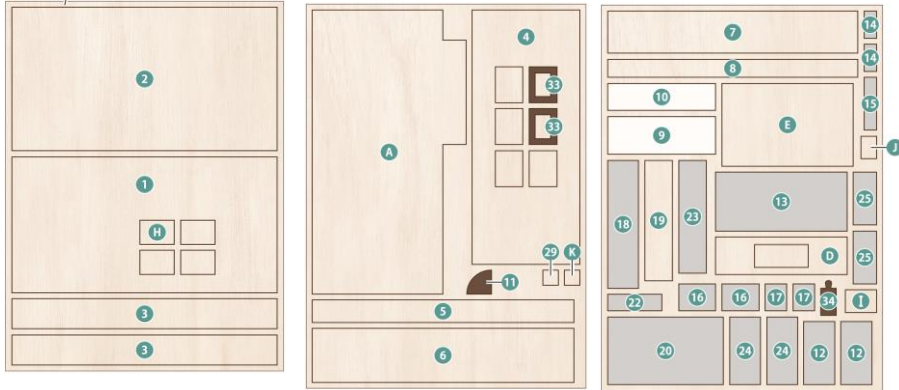

Cut an edge off the toothpick at 45 degrees.

Cutting fabric

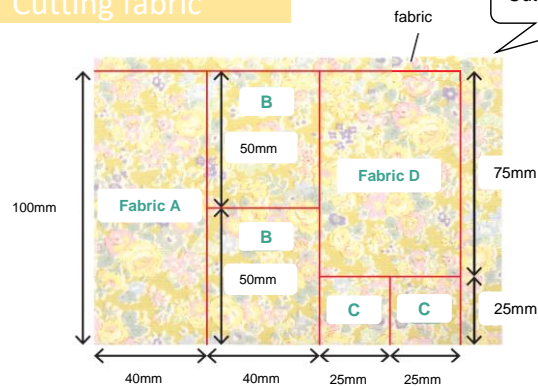

Cut the fabric in red line.

From the fabric, pull out some of the thread to make it loosen.



Preparing wire parts

Creating the shape before cutting wire with nippers.
* Extensive bending of wire may cause breakage.

<Bending wire>



Creating a circle in the material with the end of a pen.



Pinch the end of the wire with pliers, and bend it.

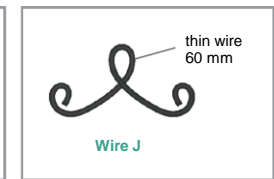
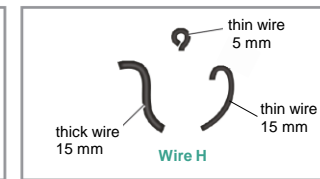
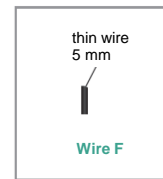
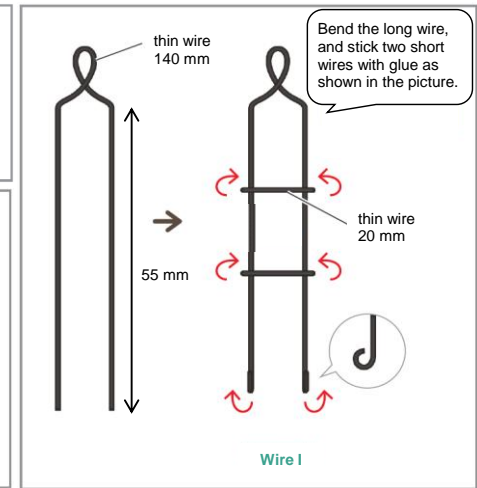
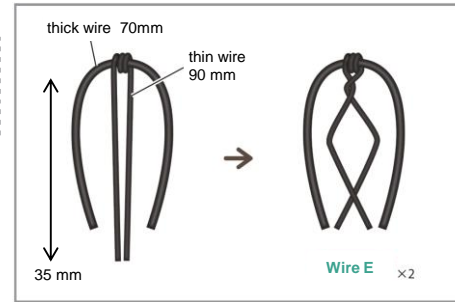
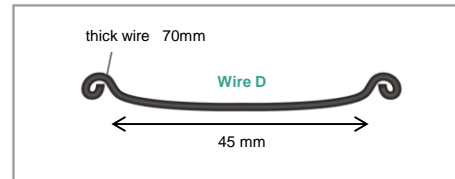
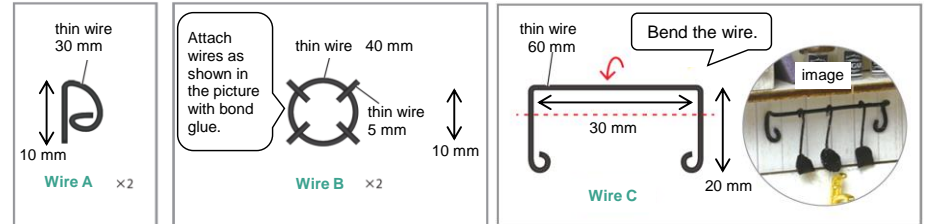

Please see numbers and letters: Paper parts ○ Wooden parts ● toothpick, fabric, hemp fabric and wire ○

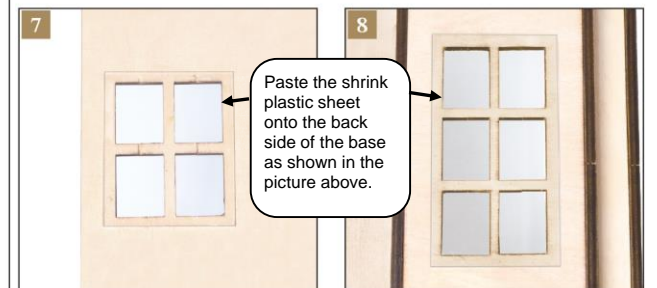
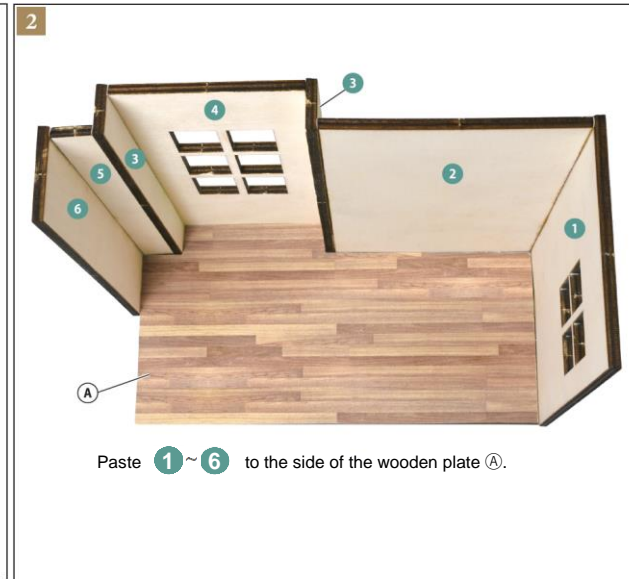
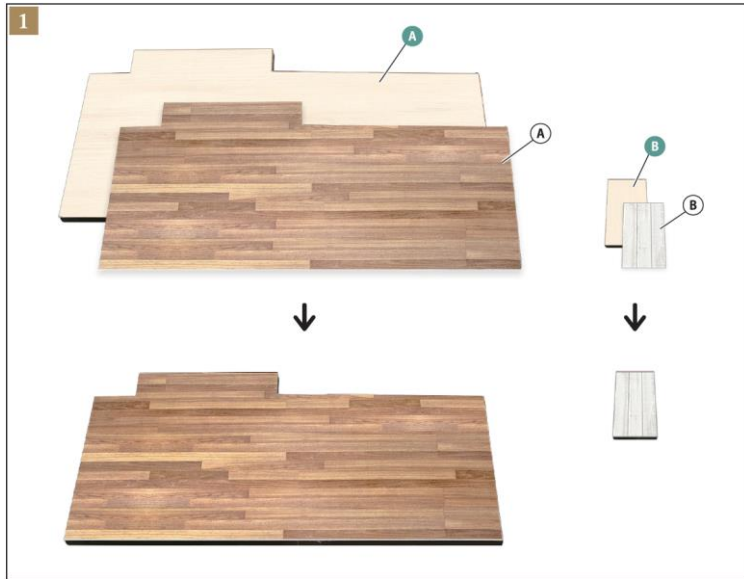

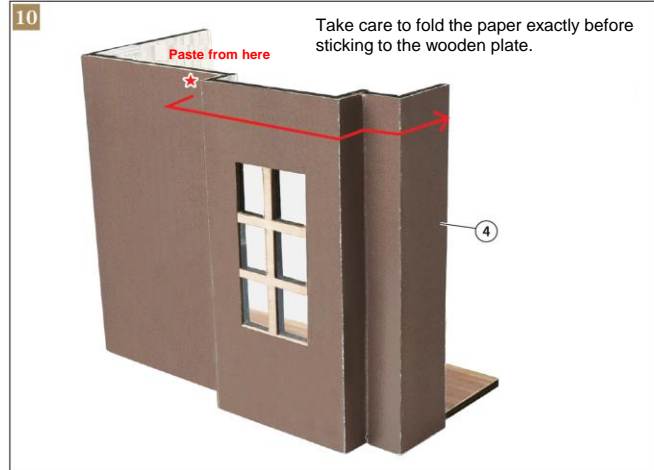
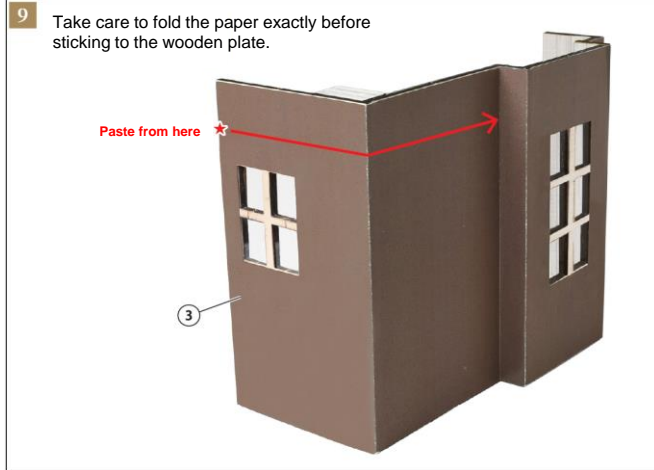

Cut a few millimeters into the craft band with scissors. Put the PP cutter into the band and slide it through to create strings for the window frame etc.

Ensure use the correct color of band for each design element.

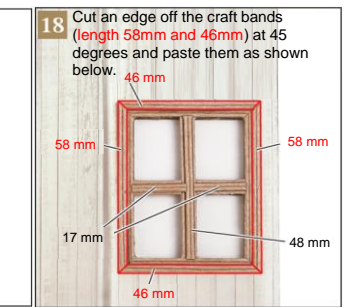
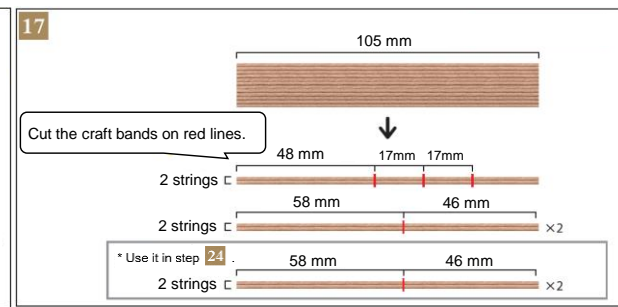
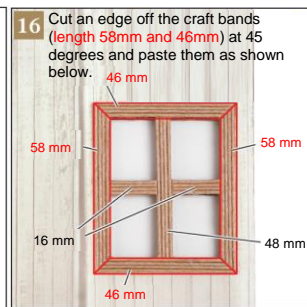
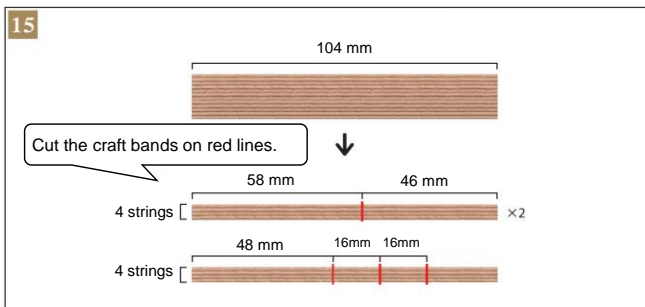
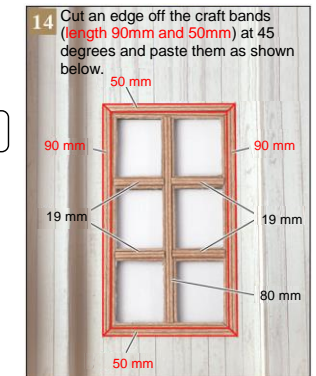
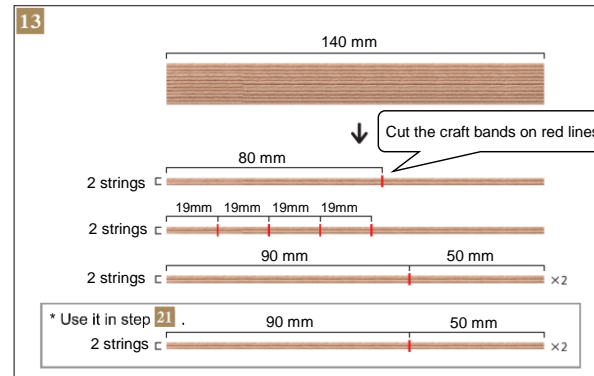
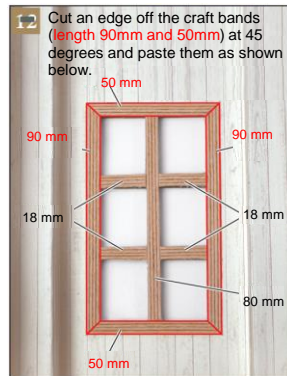
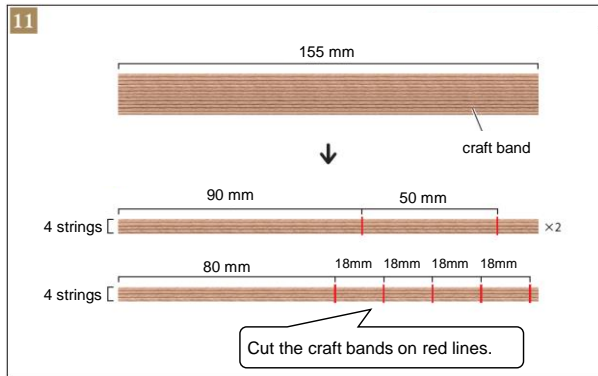
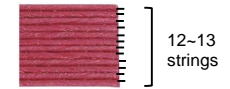

Cut an edge off the craft bands (length 90mm and 50mm) at 45 degrees and paste them as shown below.

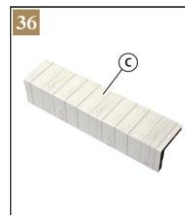
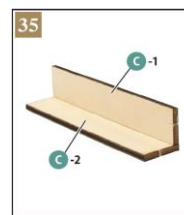
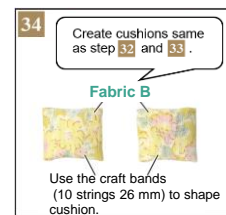
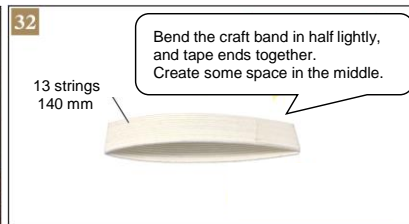
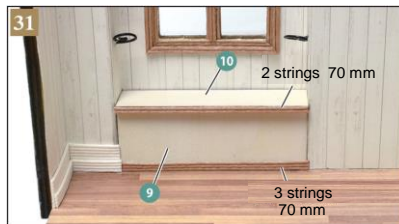
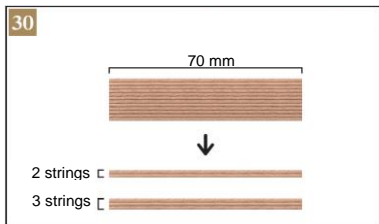
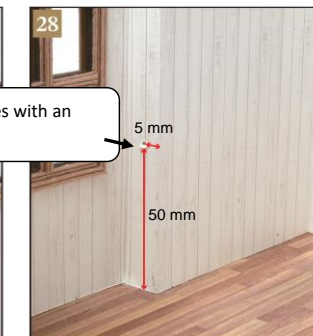
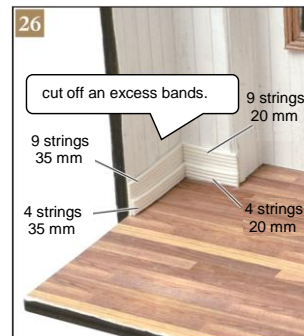
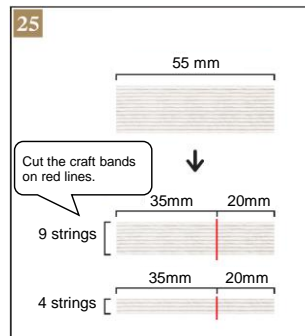
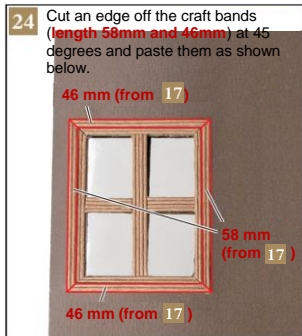
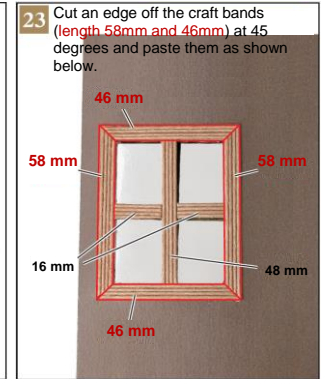
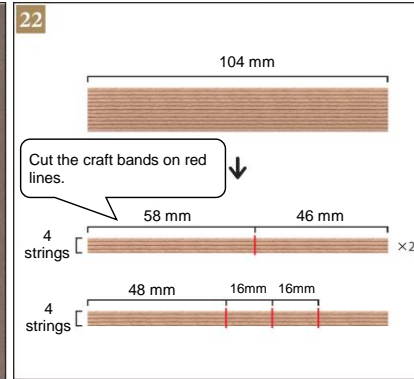
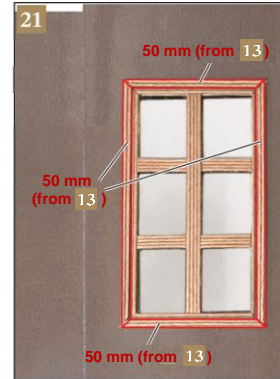
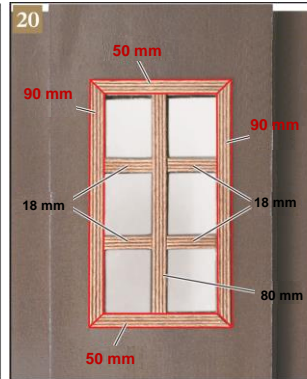
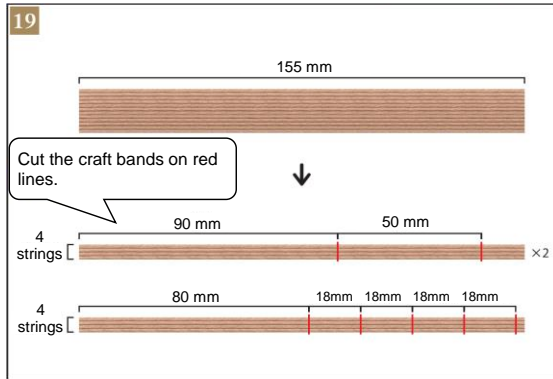

Creating kitchen

39 Add etching on the craft band and bend it.

Tape the craft band as shown below.

40

41

42

43

44

45 Using 21, dry run before finally fixing to the products.

Go to the next step before drying the glue.

46

47

52

48

Cut an edge off the craft bands at 45 degrees and paste them as shown below.

49

50

51

53

54 Place the lace onto the table.

55 Paste "型紙A" onto the craft band, and cut it along the line.

12 strings 40 mm

56 Fabric C

Cut into the red dot lines to create circle.

57 Tape "型紙B" to the wooden piece 32, and open holes at 33 with an eyelet.

型紙B(表) 型紙B(裏)

< Front surface > < Back surface >

32 Front Back x2

58 Shape the Wire E as shown below.

59 Color the part white.

60 Use a box to form chair back position while glue is setting.

toothpick B

Creating decorative parts

61

62

63

Fold in half and stick together.

Cut along the line. Color the cross section black.

64

Open a hole in center with an eyelet.

Wire F

65

eye pin

15 mm

<side view>

6

Fold the paper parts in half.

Shape eye pins as shown picture, and color them black.

66

Add etching on the craft band and bend it.

Overlapping part
Outside: 10 mm
Inside: 9 mm

78 mm

6 strings [10mm 25mm 10mm 24mm 9mm]

67

Add etching on the craft band and bend it.

Overlapping part
Outside: 10 mm
Inside: 9 mm

78 mm

10 strings [10mm 25mm 10mm 24mm 9mm]

Use in step 61. 10 mm

2 strings c [] Cut in red line.

68

12 strings
40 mm

69

40 mm

Use in step 70.

2 strings c [] x2

25 mm

2 strings c [] x3

8-1

8-2

straw
10 mm

70

Paste "型紙 C" onto the craft band, and cut it along the line.

30 mm

12 strings
25 mm

6 strings [] x2

2 strings 40mm from 68

9

71

Paste "型紙 D" onto the craft band, and cut it along the line.

45 mm

12 strings
30 mm

2 strings c [] x2

35 mm

6 strings [] x2

10

72

11

73

Tape the paper parts as shown below.

Open the holes with an eyelet. Paste glue on wire G, and put them into the paper parts 12.

Wire G

74

Create a kettle same as step 73.

Wire H

75

Tape the paper parts as shown below.

Fold in half.

Cut out a dish precisely. Put it on a soft surface, then shape the dish with a cotton bud.

Create all the dishes same as before.

15

76

Wire I

81

2 strings
10 mm from 67

33

82

Wire J

33

34

fabric E

77

Create dish same as 75 and cut it in half.

Create cup same as before.

jump ring cut in half.

bead cap

16

78

17

79

fabric D ① Cut in red line.

"型紙 E" ② Cut in dot red line.

18

80

preserved flower

cork

bead B