

**NTR-54 Home Décor NATURAL HOUSE
MY FAVORITE RESTAURANT**



TOOLS NEEDED

craft bond glue / utility knife / cutting mat / scissors / ruler / flat-nose pliers / round-nose pliers / nippers / water bowl (for rinsing paintbrush) / palette / pencil / wet towel / eyeleteer / sand paper / wooden stick / tissue paper / scotch tape

NOT NECESSARY BUT CONVENIENT

tray for parts / paper / tweezers / glue-gun clothespin or hairpin (tools which hold something)

Read the following before you start.

* Please check if the contents are all included.
* Please follow the TIP, reference information, and images for your reference.

* You will need:
a wooden stick...to use bond glue.
a wet towel... to wipe your hands and to clean your place.
a paper... when using bond glue and not to get dirty.
tweezers... for detail work.
A glue gun is also useful instead of a traditional glue.

* Please adjust the length of natural flowers and preserved moss based on the place where you want to use it. Divide the materials and dry run before finally fixing to the products.

* Printed images may be come off when rubbing the paper parts with an eraser or a wet towel.

* Extensive bending of wire may cause breakage.

Basic TIP reference · preparation

Please follow **Example of completed design** when you make.

Caution!

Keep out of reach of children and pets. Maybe harmful if swallowed.

Manufacturer: Eruberu Co., Ltd

2-1-20 Ekimae Ibaraki Osaka Japan <https://eruberu.co.jp/>

Content

Wooden base A		1
Wooden base B		1
Wooden base C		1
Plant A		1
Plant B		1 pouch
Plant C		1 pouch
Plant D		1 pouch
Gravel		1 pouch
Miniature Streetlamp		1
Cork(small)		Approx. 3
Cork(large)		1
Beads		Approx. 2
Craft band (gray)	Craft band (red)	1 each
Craft band (beige)	Craft band (two-tone)	
Craft band (brown)	Craft band (black)	
Wire (thin)		Approx. 2
Wire (thick)		1
Toothpicks		Approx. 17
Paper part		6
Film		1
Plastic board		1

Acrylic Paint (brown)	1
Acrylic Paint (white)	1
Acrylic Paint (black)	1
Paintbrush	1
PP band (packing string)	1
Instruction sheets (including pattern sheet)	9

* Images may vary to actual contents. * For materials in this kit, their colors, shapes, sizes and pattern may vary, due to manufacturing process. Natural wooden plates are naturally generated, their colors and wood grain will not be identical. * The wooden plate may warp slightly due to the excessive humidity. * Make an eye pin straight before use. * For the metal parts, it is possible to have certain amount of flaws on the surface, due to plate coating process. * Because of the polyester cloth, red thread may be stucked.

[About Preserved moss and flower]

* Preserved moss and flowers may get on your clothes, wall or floor.

* If moss is exposed to fluorescent light or direct sunshine for long time, the colors may fade. Store in a cool, dry place away from direct sunlight. * Depending on the season, the colors, shapes and sizes of moss may vary. * This product is specially for craft. Do not eat.

Basics

Images are just samples. Images may be different from the kit contents.

A How to separate the wooden pieces from the wooden plate

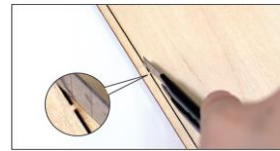

TIP!
Sand cut surfaces after removal.

Cut off the wood pieces with craft knife as shown in the picture above. (use cutting board below)

* This wooden plate is laser processed. Wipe cut surfaces to remove dirt and dust before use.

B How to split the craft band



1 Make a notch with scissors on the end of the craft band.



2 Insert the PPband into the notch and slide it to the other end.

TIP

Tip 1

Ensure use the correct color of band for each design element.

*The craft bands vary slightly in width or the number of twisted paper strings, depending



12~13 strings

Tip 2



Hairpin

*This image is for your reference.

The parts will be fixed firmly if you hold them with a clothespin or hairpin until the craft bond glue dries.

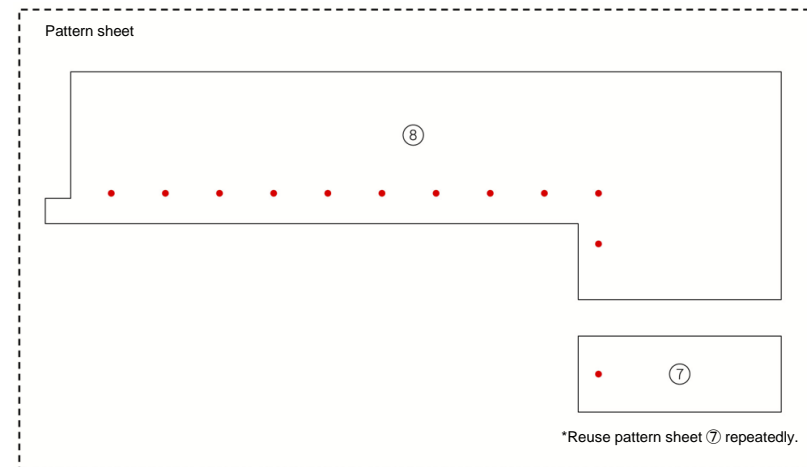

*Reuse pattern sheet ⑦ repeatedly.

reference preparation

*While making your artwork, please refer to the numbers printed on each

Paper parts

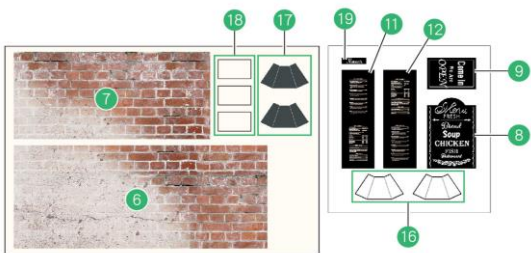
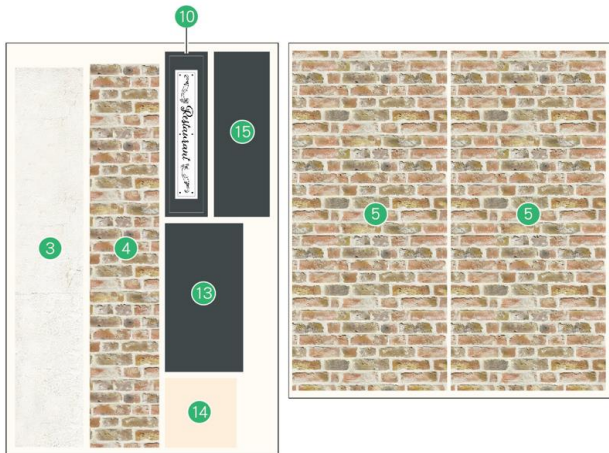
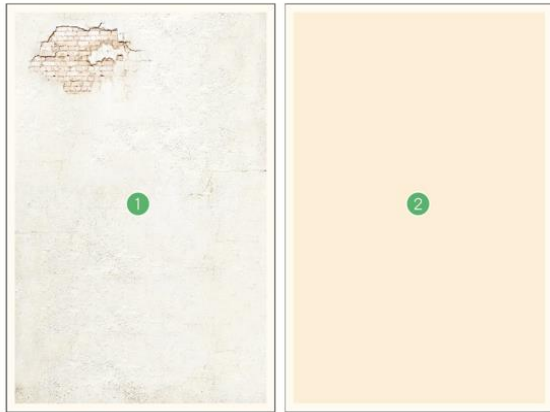

Wooden base A

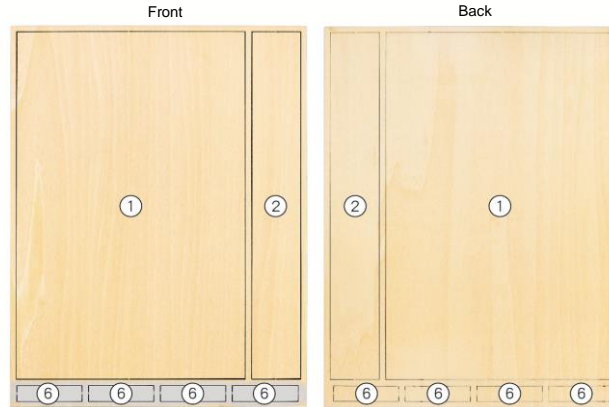

Wooden base B

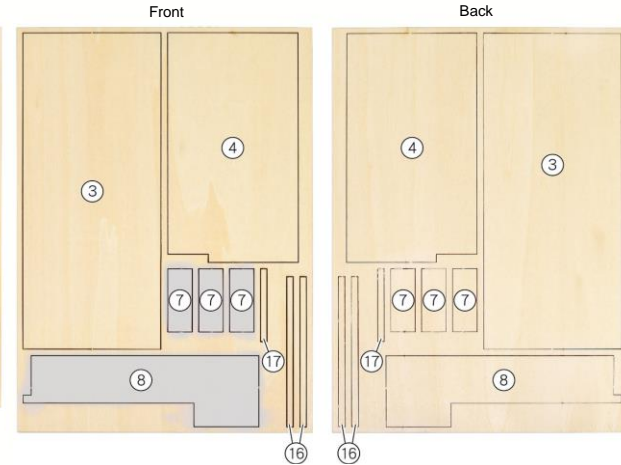

Wooden base

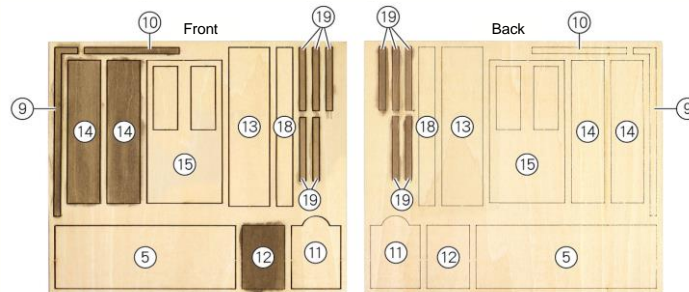

Toothpick



Mix the Acrylic paints, paint the Wooden base and the Toothpick.
*Save the paint (white). The rest of the paint will be used in 66.

Example of mixture

Dark brown	=	Brown	:	Black
	=	1	:	1
Gray	=	Dark brown	:	White
	=	1	:	10

How to make

Create a base

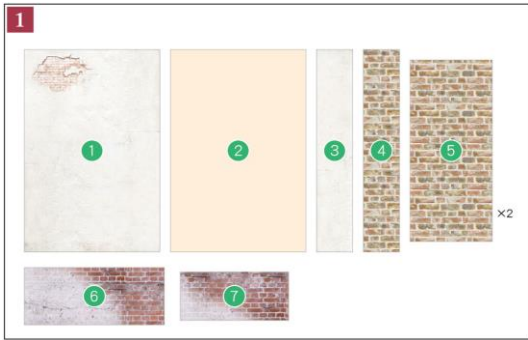

Cut out the patterns.

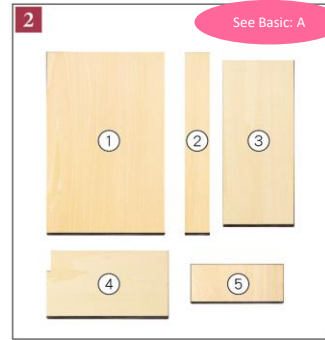

Cut apart these parts from the wooden base.

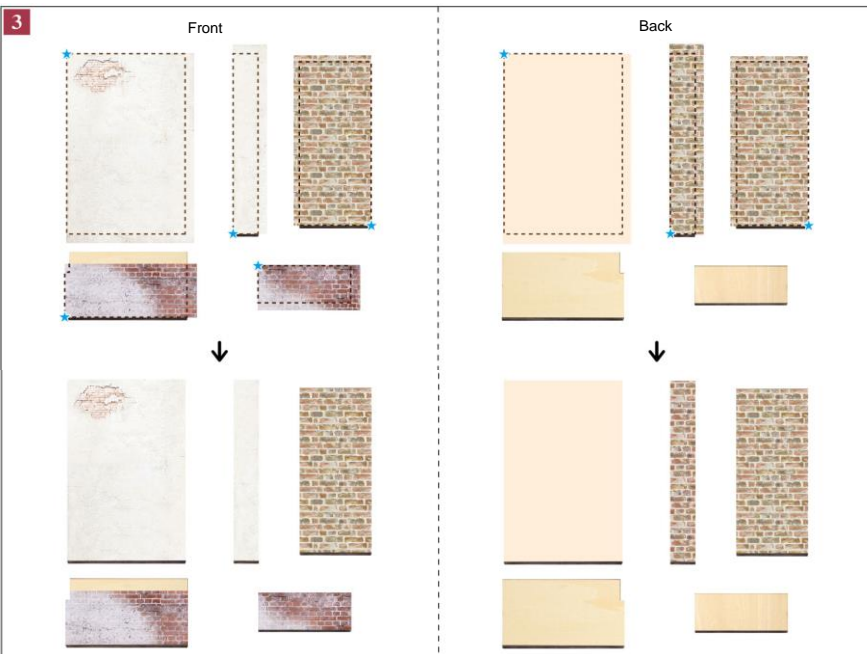

Apply craft bond glue to the parts in 2, and paste the paper parts (1) on them as shown in the picture above. After the bond dries, turn them over and cut off the protruding with utility knife. Paste at the back side in the same way.
* When you paste 1 to 2, align the corner of the paper to ★.



Paste each part with the craft bond glue as shown in the picture above.
*After the bond dries, go on the the next process.

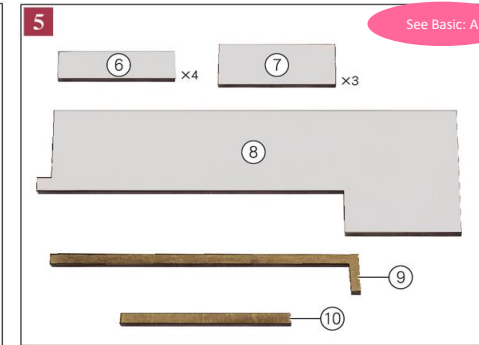

Cut apart these parts from the wooden base.

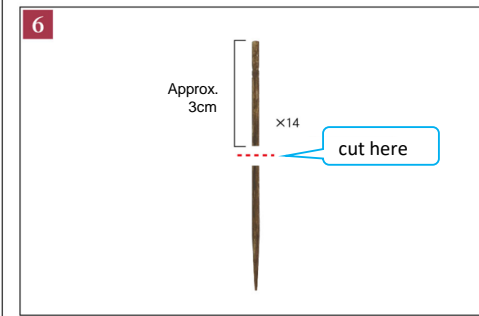

Cut 14 toothpicks into approx. 3cm with nippers.
*The toothpicks will also be used in 18・52

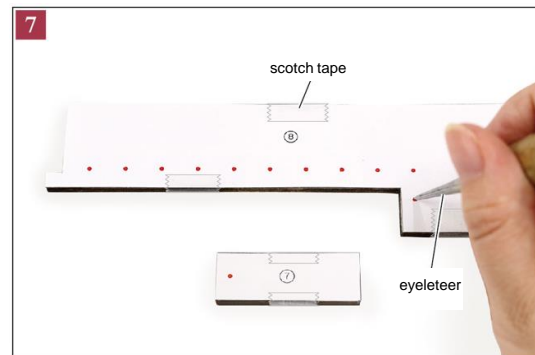

Cut out the pattern sheet on the black solid line, and paste them temporarily on 7, 8 with scotch tape. Punch holes on ●, and peel pattern and scotch tape off.

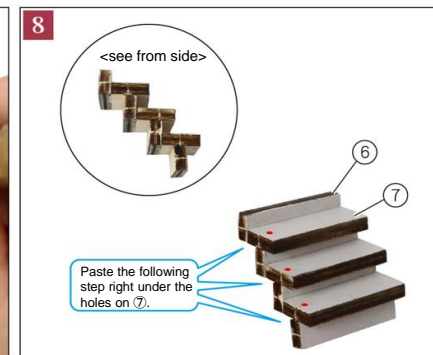

Paste 6 and 7 with the craft bond glue as shown in the picture above.
* After the bond dries, go on to 10
* Lay down the parts if needed.

* Please see Japanese instruction page1. There is an actual size pattern.

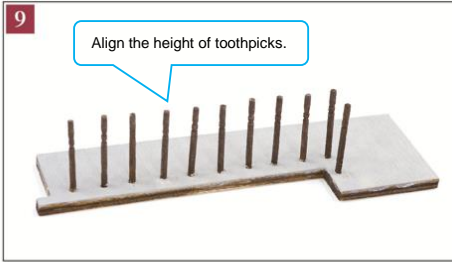

Apply the craft bond glue inside the holes made on ⑦ in 7, and insert toothpicks of 6 into the holes.
 *After the glue dries, go on to the next process.
 *The rest of toothpicks will be used in 13.



Put together each part with the glue.
 *After the glue dries, go on to the next process.

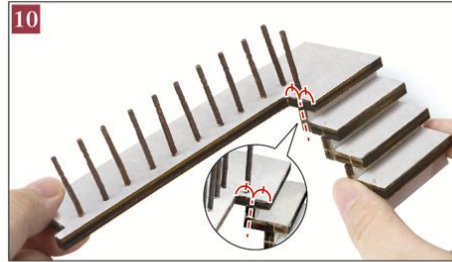

Paste 8 and 9 with the glue as shown in the picture above.
 *After the glue dries, go on to the next process.



Paste 9 with the glue as shown in the picture above.
 *After the glue dries, go on to the next process.

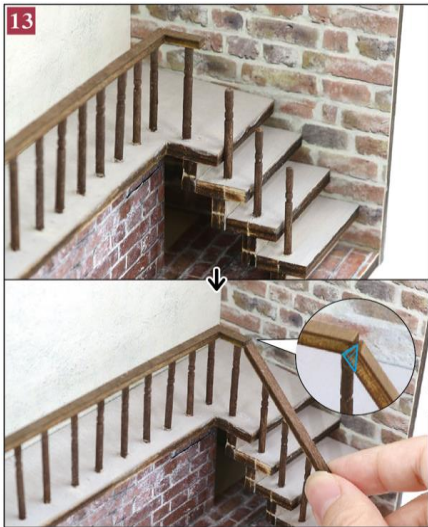

Apply the glue inside the holes made on ⑦ in 7, insert the toothpicks of 6 into the holes. Put 10 on the inserted toothpicks and make sure all the toothpicks touch 10 in order to align the height of the toothpicks.
 Cut off the 10 with utility knife, paste it to the upper handrail.

*After the glue dries, go on to 63



Create Sign A



Cut apart each part, and paste each other with the glue.

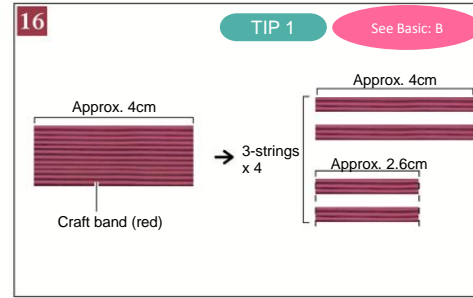

Cut the craft band into approx. 4cm and cut into the smaller pieces as shown in the picture above.
 *Craft band (red) will also be used in 38

Create Sign B



Cut apart each parts, and paste each other with the glue.

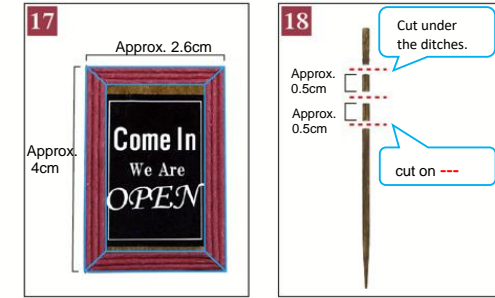

Cut off the edges of 10 at 45 degrees, and paste each other with the glue.

Cut out the toothpick into four pieces as shown in the picture above with the Nippers.
 *The toothpick will be also used in 59

Create Sign C



Paste the toothpicks of 18 to the Sign B with the glue.
 *After the bond dries, go on to 66



Cut apart the parts, and paste each other with the glue.

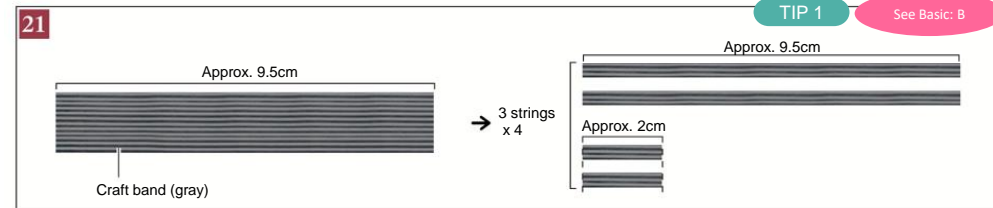

Cut out the Craft band (gray) into approx. 9.5cm, and split it into the smaller pieces as shown in the picture above.
 *Craft band (gray) will also be in 30 • 35 • 37

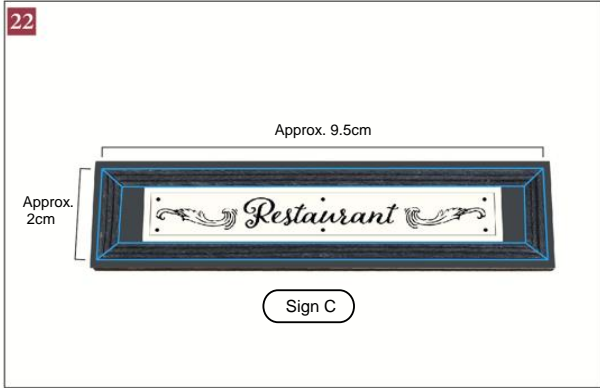

Cut off the edges of the Craft band 21 at 45 degrees, paste it inside the paper part with the glue.

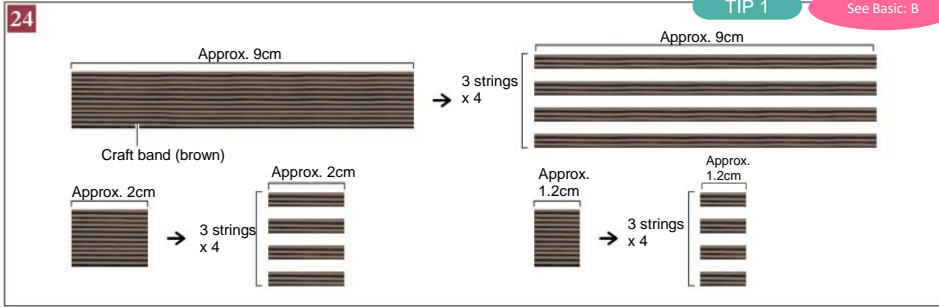

Cut out the Craft band (brown) into approx. 9cm, 2cm and 1.2cm. Split each piece into smaller pieces as shown in the picture above. *Craft band (brown) will also be used in 31

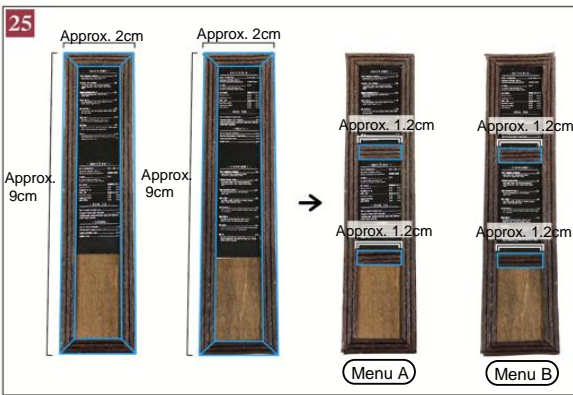

Cut off the edges of 24 (3 strings of approx. 9cm and 3 strings of approx. 2cm) at 45 degrees. Paste each part as shown in the picture above.

Create a menu board



Cut apart each part and paste with the glue.

TIP 1 See Basic: B

Create a door

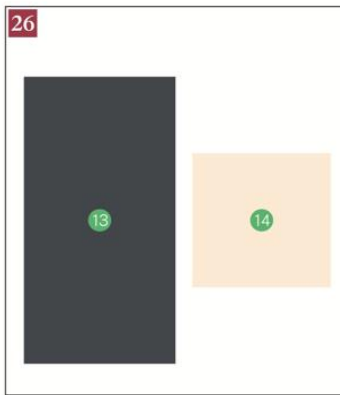

Cut out the paper parts.



Cut apart 15, paste 16 on it. After the glue dries, turn it over and cut off the protruding with utility knife.

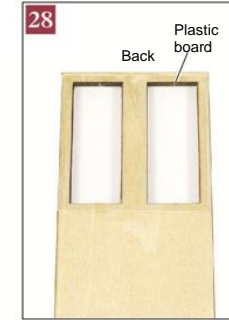

Paste the Plastic board with the glue.



Paste the front side of the door, 14 on the back of the door.

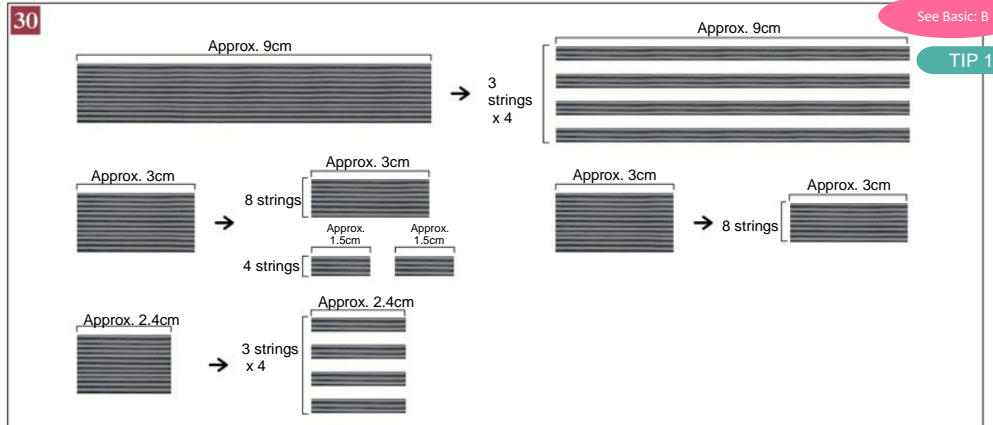

Cut out the Craft band (gray) into approx. 9cm x 1 piece, 3cm x 2 pieces and 2.4cm x 1 piece. Split each piece into smaller pieces as shown in the picture above. * Craft band (gray) will also be used in 35, 37

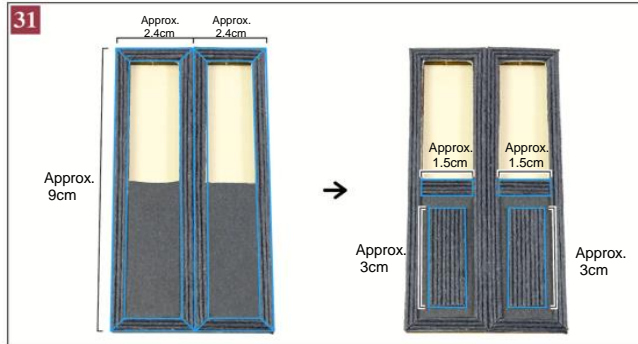

Cut off the edges of 30 (3 strings of approx. 9cm and 3 strings of approx. 2.4cm) at 45 degrees. Paste each part as shown in the picture above with the glue.

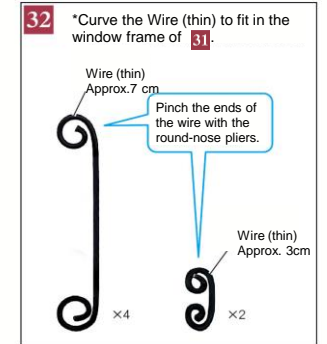

Cut out the Wire (thin) into 7cm x 4 pieces to make ornaments on the window. And cut out the Wire (thin) into 3cm x 2 pieces to make door handles. *The Wire (thin) will also be used in 33, 40, 42, 55

* Please see Japanese instruction on page 5. There is an actual size pattern.

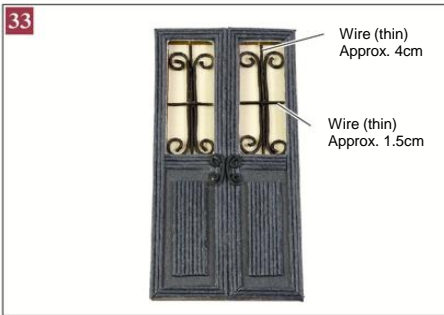

33 Cut out the wire (thin) into approx. 4cm x 2 pieces and 1.5cm x 2 pieces. Paste curved wires to the door part with the glue.
* Wire (thin) will also be used in 40, 42, 55



34 Cut apart 16 and 17, and paste them with the glue.

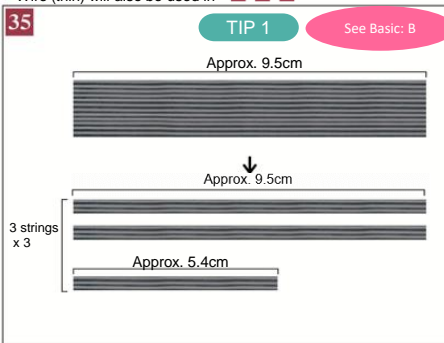

35 Cut out the Craft band (gray) into approx. 9.5cm, split it as shown in the picture above.
*Craft band (gray) will also be used in 37

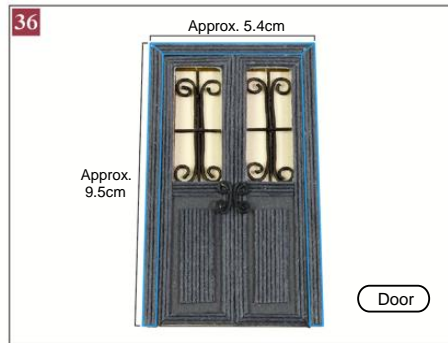

36 Cut off the edges at 45 degrees of the craft band in 35, and paste them as shown in the picture above..

Create an awning

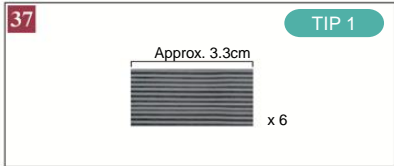

37 Cut out the craft band (gray) into approx. 3.3cm x 6 pieces.

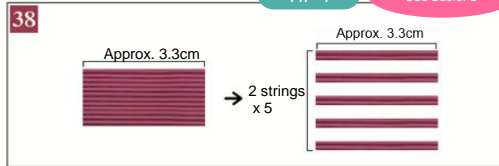

38 Cut out the craft band (red) into approx. 3.3cm. Split it into 5 pieces as shown in the picture above.



39 *Refer to the photo in 41
Cut out 15 and apply the glue on the gray face, paste the craft band of 37, 38 as shown in the picture above. Cut out the film and paste on the Craft band. Add etching on 15 with the utility knife and fold there.

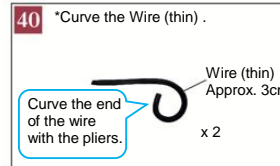

40 *Curve the Wire (thin).
Cut out the Wire (thin) into approx. 3cm x 2 pieces and curve the edge as shown in the picture above.
*The wire (thin) will also be used in 42, 55

* Please see Japanese instruction on page 6. There is an actual size pattern.



41 Cut apart 18, paste each part with glue. *After the glue dries, go on to 64

Create a lamp

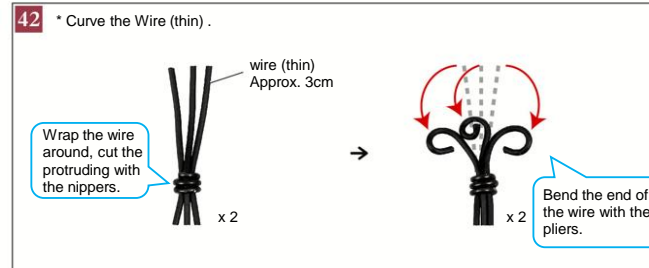

42 * Curve the Wire (thin).
Cut out the wire (thin) into approx. 3cm x 8 pieces. Wrap 1 piece around the rest (to bundle 3 pieces) and curve the edges as shown in the picture above.
*Wire (thin) will also be used in 55

* Please see Japanese instruction on page 6. There is an actual size pattern.



43 Apply the glue to the end of the wire of 42, insert the bundle into the hole of the bead.

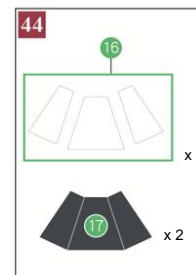

44 Cut out the paper parts.

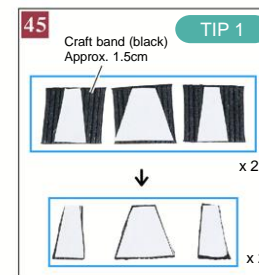

45 Cut out the craft band (black) into approx. 1.5cm x 6 pieces. Paste 16 to the craft bands and cut the craft bands along the shapes of 16

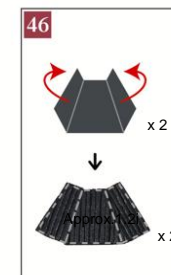

46 Fold 17 on 16, paste parts made in 45 on the gray face with the glue.



47 Put 43 and 44 together as shown in the picture above with the glue.

*After the glue dries, go on to 63

Create a bench

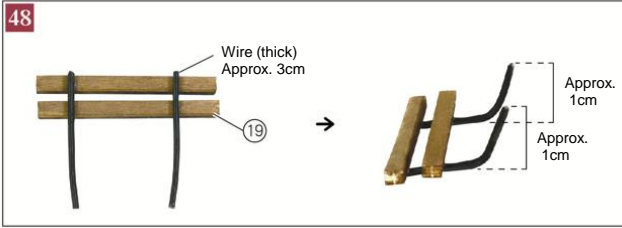

Cut off 19. Cut the wire (thick) into approx. 3cm x 2 pieces and paste them on 19 with the glue. After the glue dries, bend the wire (thick) at approx. 1cm from the edge.
* Wire (thick) will also be used in 49 * The remaining of 19 will be used in 50

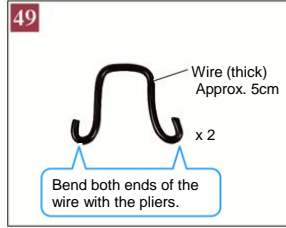

Cut out the wire (thick) into approx. 5cm x 2 pieces, bend them as shown in the picture above.
* Please see Japanese instruction on page 7. There is an actual size pattern.



Paste 49 on 19.
*After the glue dries, go on to the next process.

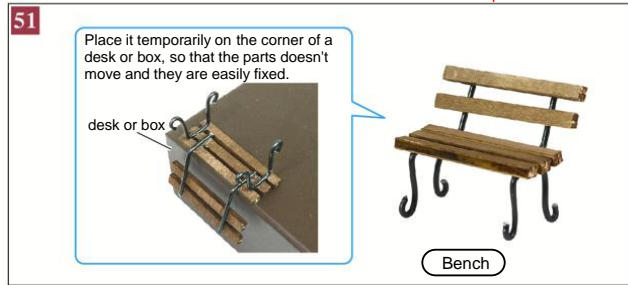

Paste 48 and 50 together with the glue.
* After the glue dries, go on 66

Create a planter A

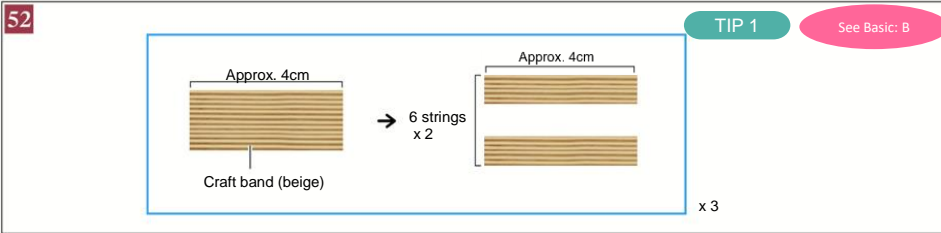

Cut out the craft band (beige) into approx. 4cm x 3 pieces and split them as shown in the picture above.
*The craft band (beige) will also be used in 56

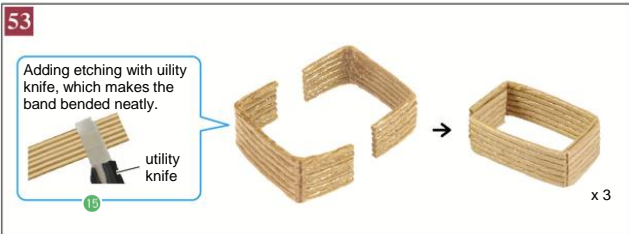

Bend 52 at approx. 1cm from the both ends as shown in the picture above. Paste these parts together with the glue.



Cut out 18, paste it on 53 with the glue to make a bottom.

Create Planter B

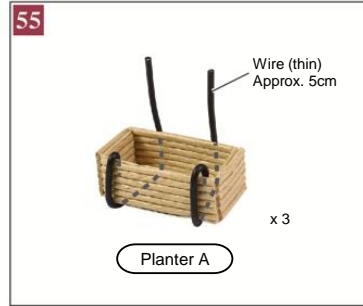

Cut the wire(thin) into approx. 5cm x 6 pieces, bend along the craft band and fix with the glue.
*After the glue dries, go on 66

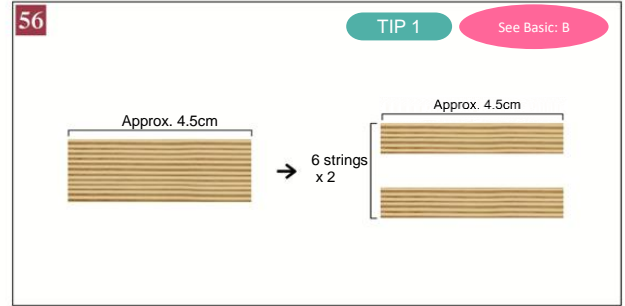

Cut out the craft band (beige) into approx. 4.5cm x 2 pieces and split them as shown in the picture above.

Create Planter C

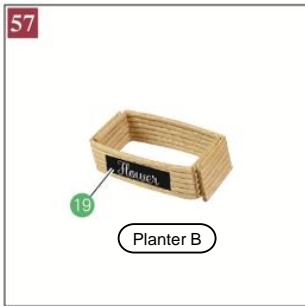

Create the planter parts the same as 53. Cut out 19 and paste it on the craft band.



Cut the craft band (two-tone) into approx. 4cm x 2 pieces, and wrap it around the pencil making it into a tube. Paste both ends together with the glue.

Create house plants

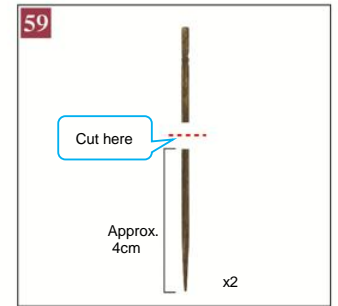

Cut a toothpick into approx. 4cm x 2 pieces with nippers.

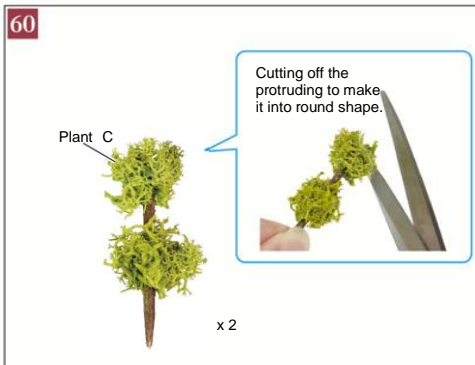

Create crumpled moss and paste it on the toothpick of 59
*Plants C will also be used in 61, 62

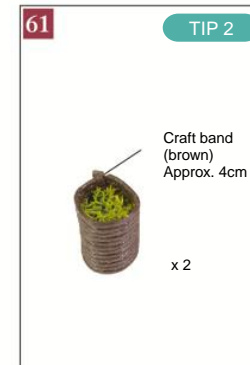

Cut the craft band (brown) into 4cm x 2 pieces. The same as 53 make planter parts and arrange preserved moss.
*Plants C will also be used in 62



Apply the glue to the end of 60, and insert it into 61.

Paste parts on the base



Lay down **Base** ,and attach **Door** on the center of **Base** . Paste other parts around the **Door**



Paste other parts with the glue as shown in the picture above.
*After the glue dries, go on to the next process.



Split the cork (large) in half. Lay down **64** in the direction convenient for you to paste the parts.
*After the glue dries, go on to the next process.



Put up **65** upright, paste each part on it with the glue. After the glue dries, paint white on **Menu A•B** **House plant** **Planter A** **Bench** as you like.

* After dipping the paintbrush in acrylic paint (white) , wipe the brush lightly with tissues, and then paint parts with the half-dried brush so that the finishing looks like the Sample of complete design.

67 Apply the glue to each part and arrange them as you like.
 *Attaching the parts on the wall (1 ~ 3) first, which will make whole work easier.

Example of completed design

