

[Tools needed]

craft bond glue, utility knife, cutting mat, scissors, ruler, needle-nose pliers, nippers, pencils, eyeleteer, sand paper, wooden stick, wet towel

[Not necessary but convenient]

tray for parts, paper, tweezers, glue-gun

[Materials included]

wooden plate, artificial flowers, preserved moss, gravel, shells, cork, wire, paper parts, shrink plastic sheet, craft bands (white, brown, beige), instruction manuals

* Image printed on instruction sheet may have a certain level of color difference to the actual object. * The actual object may also have certain differences compared with the image printed here. * For the materials in this kit, their colors, shapes, sizes and pattern may vary, due to the manufacturing process. Natural wooden base are naturally generated, their colors and wood grain will not be identical. * The wooden base may be warped slightly because of the excessive humidity. * Because of the nature of shells, their colors and shapes and sizes may vary.

[About Preserved moss]

* Preserved moss may get on your clothes, wall or floor dirty, or may bleed on to them. * If moss are exposed to fluorescent light or direct sunshine for long time, the colors may fade. Store in a cool, dry place away from direct sunlight. * Depending on the season, the colors, shapes and sizes of moss may vary. * This product is specially for craft. Do not eat.

Read the following before you start.

* Please check if the contents are all included.
* Please follow the TIP, reference information, and images for your reference.

*** You will need:**

a wooden stick...to use bond glue.
a wet towel... to wipe your hands and to clean your place.
a paper... when using bond glue and not to get dirty.
tweezers... for detail work.
A glue gun is also useful instead of a traditional glue.

* Please adjust the length of natural flowers and preserved moss based on the place where you want to use it. Divide the materials and dry run before finally fixing to the products.

* Printed images may be come off when rubbing the paper parts with an eraser or a wet towel. * Extensive bending of wire may cause breakage.

TIP

Tip 1

Ensure use the correct color of band for each design element.



12~13 strings

References

Refer to this 'material reference' when identifying parts for use.

Paper

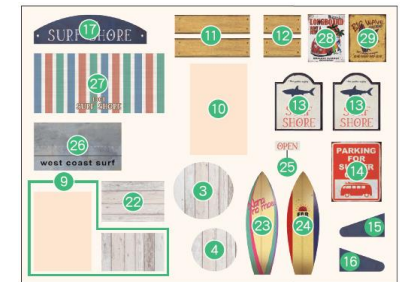
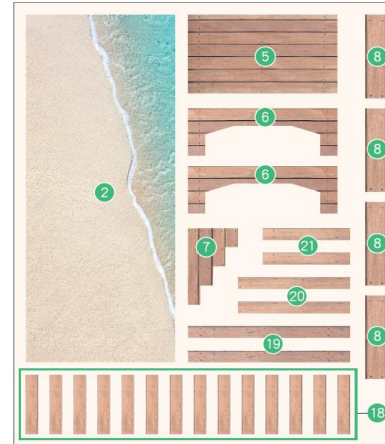
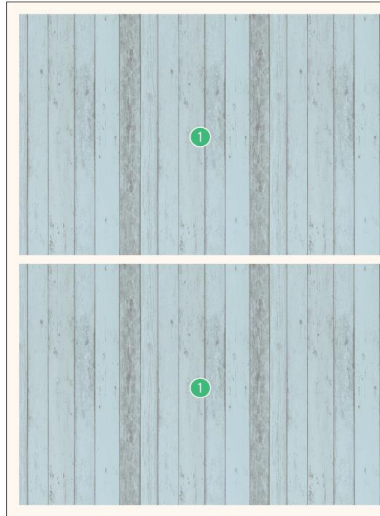

Basics

Images are just samples. Images may be different from the kit contents.

A How to separate the wooden pieces from the wooden plate



TIP!
Sand cut surfaces after removal.

Cut off the wood pieces with craft knife as shown in the picture above. (use cutting board below)

* This wooden plate is laser processed. Wipe cut surfaces to remove dirt and dust before use.

Wooden plate

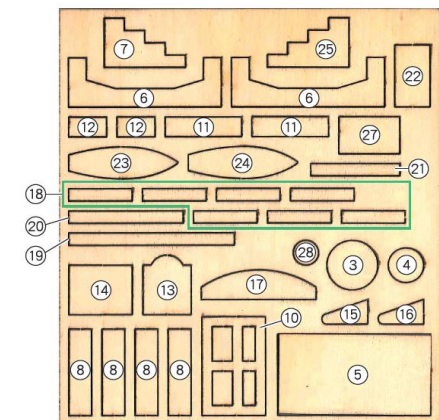
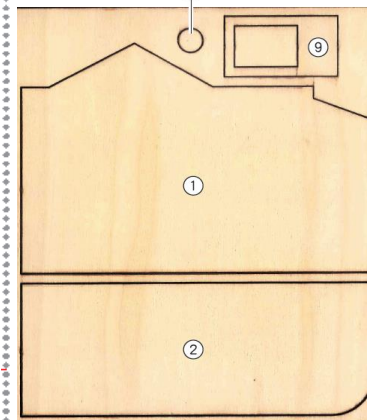

Caution!

Keep out of reach of children and pets. Maybe harmful if swallowed.

Manufacturer: Eruberu Co., Ltd

2-1-20 Ekimae Ibaraki Osaka Japan <https://eruberu.co.jp/>

How to make

Attach paper parts on the wooden pieces

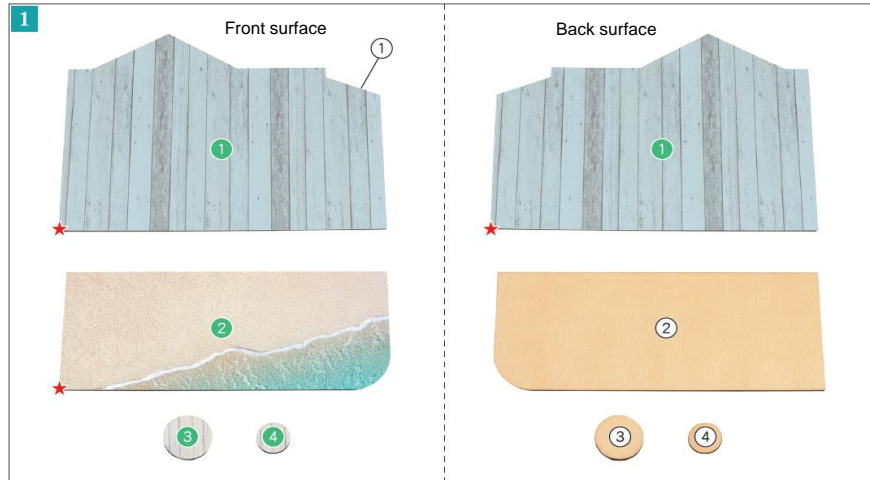

Separate each wooden piece from the wooden plate. Paste craft bond glue on the wooden piece ①~④ and attach paper parts ①~④ on them. After the glue dries, cut the excess paper off with a craft knife. Also, attach the paper parts on the back side.

* Stick the same number parts together.

* When pasting paper ① and ② to ① and ②, align the wooden piece and paper parts at the ★oint.

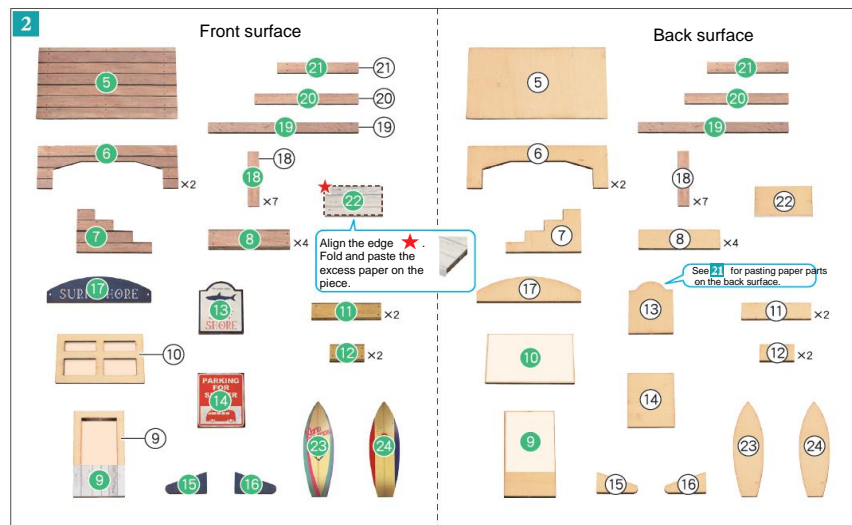

Create the base

③ ~ ⑥ Put each wooden part together as shown in the picture below with bond glue.

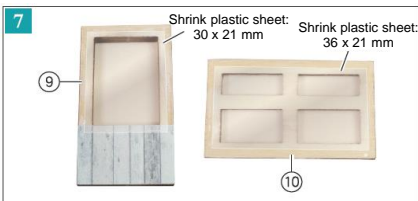

Cut a slice of shrink plastic sheet in two;
30 x 21 mm, 36 x 21 mm
Attach them to ⑨, ⑩ with the glue.

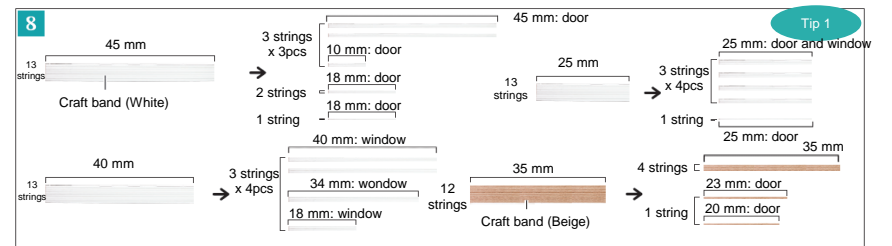

Cut a white craft band in three; 45 mm, 40 mm and 25 mm.
Cut a beige craft band to 35 mm. See above for details.

* White craft band is also used in step 12. Beige craft band 4 strings 35 mm is used in step 13.

NTR-56

Create a door and a window

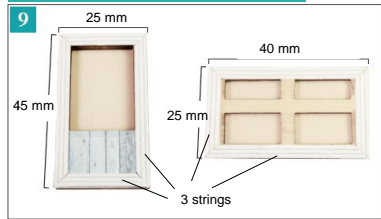

Cut an edge off the white craft bands at 45 degrees. Paste them to the wooden parts with the glue.

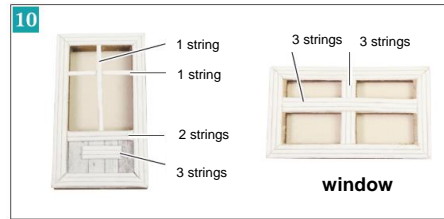

Attach white craft bands to the wooden parts with the glue as shown in the picture above.

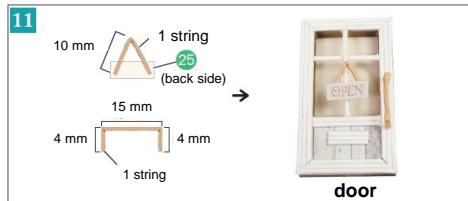

Cut part 25. Bend one string of beige craft band as shown in the picture above, and attach them to the door part with the glue.

Create a table



Cut white craft band in 66 mm. Then, cut the band again as shown in the picture above.

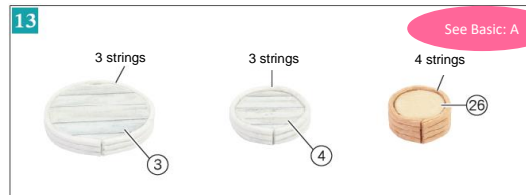

Separate wood part 26 from the wooden plate. Paste the craft bond glue to the side of round part 3 4 26, and attach craft band to those wood parts as shown in the picture above.

Create a box



Separate wood part 27 from the wooden plate. Attach all the parts together with the glue as shown in the picture above.

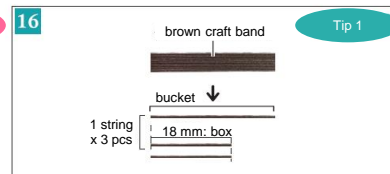

Divide brown craft band as shown in the above.

* Use the non-cut brown craft band (1 string) is used in step 19

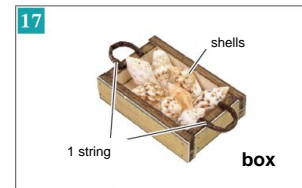

Attach shells and brown craft bands to a box as shown in the picture above.

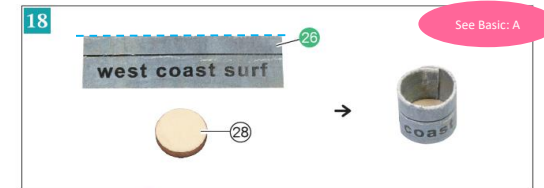

Separate part 28 from the wooden plate. Cut 26 and fold it in half, then attach it with glue. Paste the craft bond glue on the side of 28 and wrap around 26 base to create the bucket.



Attach the brown craft band as shown in the picture above.

Create a signboard

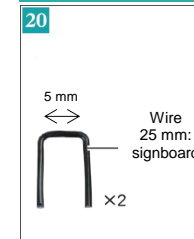

Cut the wire in 25 mm x 2 pcs, and fold them as shown in the picture above.

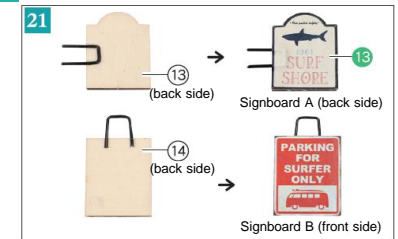

Paste the glue to each wooden part and attach them as shown in the picture above. Paste 13 on the back side of the signboard A.

Create an eave

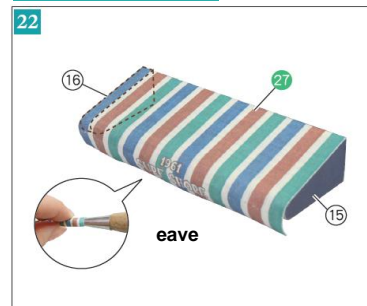

Cut out the paper part 27. Create a curve in the material with the end of a pen, and attach all the parts together with the glue as shown in the picture above.

Create plants



Cut the cork in half, and create a hole in the center of it with an eyelet.

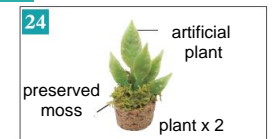

Paste the glue to the artificial plant and insert them to the cork. Also, paste the preserved moss around the plant.

Create posters

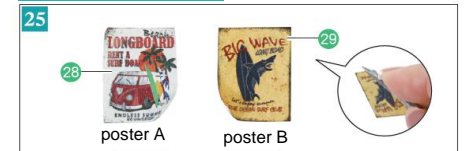

Cut 28 and 29. Create a curve with the end of an eyelet as shown in the picture above if designed.

Attach the parts to the wooden base

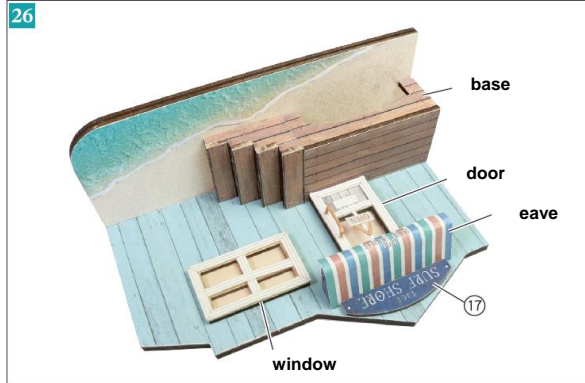

Lay the house base on its side, and attach the parts on the base with the glue.

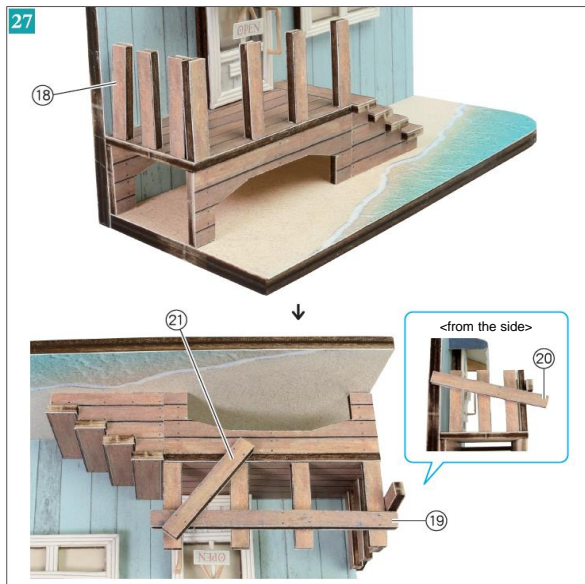

Attach the part 18 with the glue. After drying it, attach all the parts to the base with the glue.

