

[Tools needed]

LED lamp / craft bond glue / glue stick / utility knife / cutting mat / scissors / tweezers / ruler / pencil / toothpick / sand paper / nippers / Flat-nose pliers / round-nose pliers

[Not necessary but convenient]

File / tray for part / cardboard / paper / silicone mat / glue-gun / wet tissues

[Materials included]



* Image printed on instruction may have a certain level of color difference to the actual object. * The actual object may have certain differences compared with the image printed here. * For materials in this kit, their colors, shapes, sizes and pattern may vary, due to manufacturing process. Natural wooden plates are naturally generated, their colors and wood grain will not be identical. * The wooden plate may be warped slightly because of the excessive humidity.

[About Preserved moss]

* Preserved moss may get on your clothes, wall or floor. * If moss are exposed to fluorescent light or direct sunshine for long time, the colors may fade. Store in a cool, dry place away from direct sunlight. * Depending on the season, the colors, shapes and sizes of moss may vary. * This product is specially for craft. Do not eat.

Read the following before you start.

* Please check if the contents are all included. * Please refer to the images and TIP reference while building your model.

*** You will need:**

a toothpick...to use bond glue and/or resin.
a wet towel... to wipe your hands and to clean your workplace.
paper... when using bond glue and to protect surfaces while working.
tweezers... for detail work.
A glue gun is also useful instead of a bond glue.

* Work away from direct sunlight and UV ray. When you don't use lamp, please turn it off. *Place a cardboard and a silicone mat under your work, so as to keep your work desk clean. Hence, you can move your work into the lamp right away and make it more convenient. * Printed images may be come off when rubbing the paper parts with an eraser or a wet towel.

Caution!

Keep out of reach of children and pets. Maybe harmful if swallowed.

Manufacturer: Eruberu Co., Ltd

2-1-20 Ekimae Ibaraki Osaka Japan <https://eruberu.co.jp/>

PREPARATION-REFERENCES

Paper parts--- numbers in O, Parts (Wooden parts) cut out from the Wooden Base--- numbers in ●

Wooden base

Separating the wooden pieces from the wooden



Cut off the wood pieces with a craft knife as shown in the picture above.

Tip!

* This wooden plate is laser processed. Wipe cut surfaces to remove dirt and dust before use.



Craft band

Ensure use the correct color of band for each design element.

*The craft bands vary slightly in width or the number of twisted paper strings, depending on their colors.



12-13 strings

Pasting paper parts onto wooden pieces

Paste together wooden parts and paper parts of the same number.

18 19 will be used in the next process.

Paste Paper parts on one side. 1~15

* Paste on the both sides of 1

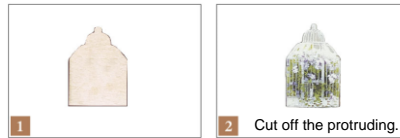

Wrap around and paste. 16~17



Cut the lace into the following lengths.

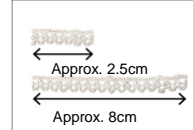

Cut them according to the lengths of 4 16

Coating parts with resin 6~15

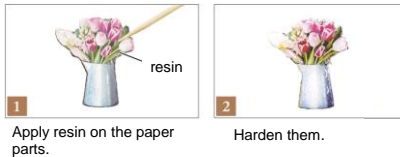

Harden resin

Time required
LED resin: 1-2 mins



Harden parts applied resin with LED lamp.

Tip!

Wipe sanded surfaces to remove dirt and dust carefully with a soft cloth. Covering sanded surfaces with resin makes the pieces beautiful finish.



Remove burrs with scissors or a craft buffer.

Create a base

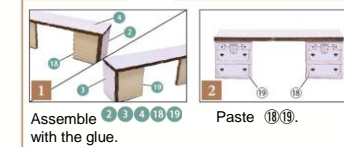

Assemble 2 3 4 18 19 with the glue.

Paste 18 19 with the glue.

Example of completed design

Enjoy stylish arrangement

Display Case designed for your TEAROOM!
 HBR-417 Perfume Bottle Acrylic case
 <sold separately>

Your artwork will look prettier when you display it in this case.

*For more inquiries, please contact us here.
<https://eruberu.co.jp>



Curve the wire

Bend the wire with pliers as below. Cut the wire after creating the shape.

* Extensive bending of wire may cause breakage.

wire

How to bend a wire (or create curve)

Pinch the end of the wire with pliers, and bend it.

Apply the glue to (13), and paste the wire on it.

* Please see Japanese instruction page 2. There is an actual size pattern.

Pearl

Bead

Apply the glue to the pearl, and paste it on the bead.

1

Craft band

Approx. 8.1cm

8 strings

Approx. 2.5cm Approx. 1.6cm Approx. 2.5cm Approx. 1.5cm

Add etching on ---, make a crease.

2

Paste both ends together with the glue.

Flower A

Flower B

Preserved moss

Cork

Apply each parts to the cork with the glue.